

Przewody kominowe typu **DWW**

PRZEZNACZENIE:

stosowany jako komin zewnętrzny w celu odprowadzenia spalin na zewnątrz budynku z urządzeń grzewczych opalanych gazem lub olejem opałowym o maksymalnej temperaturze spalin 600 °C

BUDOWA RUR I KSZTAŁTEK:

elementy dwuścienne izolowane wełną mineralną o grubości 30÷50 mm,

ZAKRES ŚREDNIC:

120/200÷500/600 mm

PALIWO:

gaz lub olej opałowy

GATUNEK I GRUBOŚĆ MATERIAŁ:

stal nierdzewna i kwasoodporna 1.4301 /opcjonalnie 1.4404, 1.4521/ o grubości 0,5÷0,8 mm

ODPORNOŚĆ NA KOROZJĘ:

Vm/V2/V3

ODPORNOŚĆ NA POŻAR SADZY:

Odporny

ODLEGŁOŚĆ OD MATERIAŁÓW PALNYCH:

100 mm

KLASA TEMPERATURY:

T 600 - 600 °C

SPOSÓB PRACY KOMINA:

podciśnieniowy

ODPORNOŚĆ NA DZIAŁANIE KONDENSATU:

D

USTNIK

201

d	D	INDEX
120	200	2011200005
130	200	2011300005
140	200	2011400005
150	225	2011500005
160	225	2011600005
180	250	2011800005
200	300	2012000005
225	300	2012200005
250	350	2012500005
300	400	2013000005
350	450	2013500005
400	500	2014000005
450	550	2014500005
500	600	2015000005

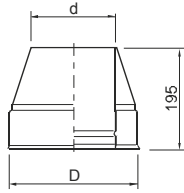

USTNIK POD PARASOL

202

d	D	INDEX
120	200	2021200005
130	200	2021300005
140	200	2021400005
150	225	2021500005
160	225	2021600005
180	250	2021800005
200	300	2022000005
225	300	2022200005
250	350	2022500005
300	400	2023000005
350	450	2023500005
400	500	2024000005
450	550	2024500005
500	600	2025000005

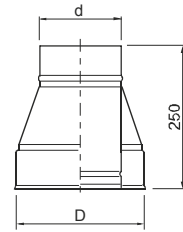

RURA

203, 204, 205, 206

INDEX					
d	D	L 1000	L 500	L 330	L 250
120	200	2031200005	2041200005	2051200005	2061200005
130	200	2031300005	2041300005	2051300005	2061300005
140	200	2031400005	2041400005	2051400005	2061400005
150	225	2031500005	2041500005	2051500005	2061500005
160	225	2031600005	2041600005	2051600005	2061600005
180	250	2031800005	2041800005	2051800005	2061800005
200	300	2032000005	2042000005	2052000005	2062000005
225	300	2032200005	2042200005	2052200005	2062200005
250	350	2032500005	2042500005	2052500005	2062500005
300	400	2033000005	2043000005	2053000005	2063000005
350	450	2033500005	2043500005	2053500005	2063500005
400	500	2034000005	2044000005	2054000005	2064000005
450	550	2034500005	2044500005	2054500005	2064500005
500	600	2035000005	2045000005	2055000005	2065000005

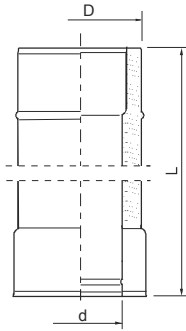

TRÓJNIK 90°

207

d	D	L	INDEX
120	200	400	2071200005
130	200	400	2071300005
140	200	400	2071400005
150	225	450	2071500005
160	225	450	2071600005
180	250	450	2071800005
200	300	500	2072000005
225	300	500	2072200005
250	350	550	2072500005
300	400	600	2073000005
350	450	650	2073500005
400	500	700	2074000005
450	550	750	2074500005
500	600	800	2075000005

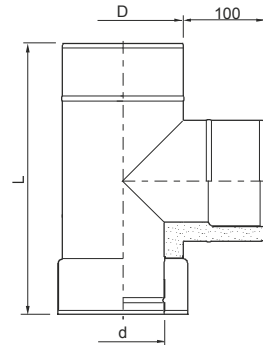

TRÓJNIK 45°

209

d	D	A	L	INDEX
120	200	350	500	2091200005
130	200	350	500	2091300005
140	200	350	500	2091400005
150	225	400	570	2091500005
160	225	400	570	2091600005
180	250	410	570	2091800005
200	300	500	700	2092000005
225	300	500	700	2092200005
250	350	550	800	2092500005
300	400	600	800	2093000005
350	450	680	900	2093500005
400	500	780	1000	2094000005
450	550	780	1000	2094500005
500	600	860	1100	2095000005

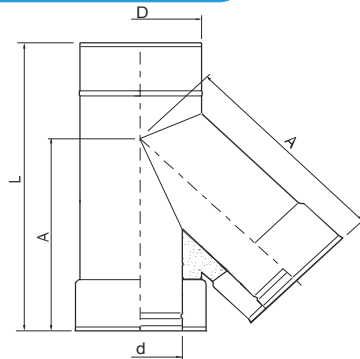

TRÓJNIK POD REGULATOR CIĄGU

210

d	D	INDEX
120	200	2101200005
130	200	2101300005
140	200	2101400005
150	225	2101500005
160	225	2101600005
180	250	2101800005
200	300	2102000005
225	300	2102200005
250	350	2102500005
300	400	2103000005
350	450	2103500005
400	500	2104000005
450	550	2104500005
500	600	2105000005

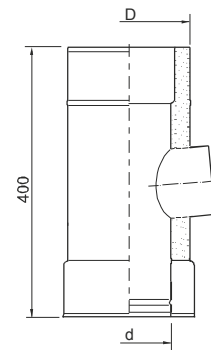

WYCZYSTKA

211

d	D	INDEX
120	200	2111200005
130	200	2111300005
140	200	2111400005
150	225	2111500005
160	225	2111600005
180	250	2111800005
200	300	2112000005
225	300	2112200005
250	350	2112500005
300	400	2113000005
350	450	2113500005
400	500	2114000005
450	550	2114500005
500	600	2115000005

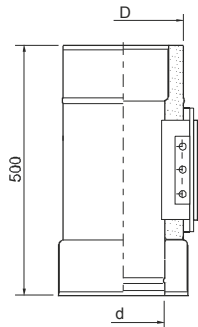

WYCZYSTKA OKRĄGLA

212

d1	d	D	INDEX
120	120	200	2121200005
130	130	200	2121300005
140	140	200	2121400005
150	150	225	2121500005
160	160	225	2121600005
180	180	250	2121800005
200	200	300	2122000005
225	225	300	2122200005
250	250	350	2122500005
300	300	400	2123000005
350	350	450	2123500005
400	400	500	2124000005
450	450	550	2124500005
500	500	600	2125000005

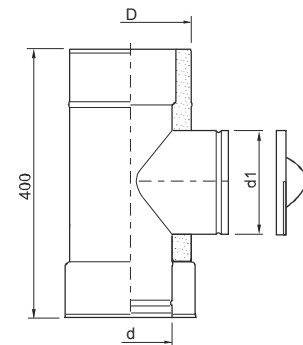

ODSKRAPLACZ

214

d	D	A	INDEX
120	200	300	2141200005
130	200	300	2141300005
140	200	300	2141400005
150	225	300	2141500005
160	225	300	2141600005
180	250	350	2141800005
200	300	400	2142000005
225	300	400	2142200005
250	350	450	2142500005
300	400	500	2143000005
350	450	550	2143500005
400	500	600	2144000005
450	550	650	2144500005
500	600	700	2145000005

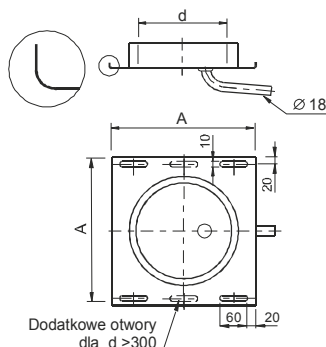

ODSKRAPLACZ - płyta prosta

248

d	D	A	INDEX
120	200	300	2481200005
130	200	300	2481300005
140	200	300	2481400005
150	225	300	2481500005
160	225	300	2481600005
180	250	350	2481800005
200	300	400	2482000005
225	300	400	2482200005
250	350	450	2482500005
300	400	500	2483000005
350	450	550	2483500005
400	500	600	2484000005
450	550	650	2484500005
500	600	700	2485000005

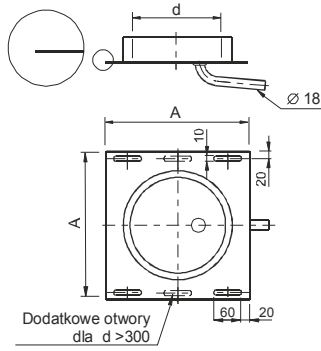

KOLANO 15°

215

d	D	A	INDEX
120	200	140	2151200005
130	200	140	2151300005
140	200	140	2151400005
150	225	160	2151500005
160	225	160	2151600005
180	250	155	2151800005
200	300	195	2152000005
225	300	195	2152200005
250	350	205	2152500005
300	400	215	2153000005
350	450	240	2153500005
400	500	240	2154000005
450	550	245	2154500005
500	600	245	2155000005

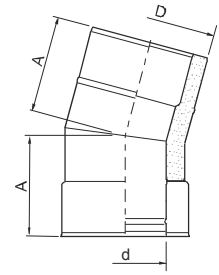

KOLANO 30°

216

d	D	A	INDEX
120	200	140	2161200005
130	200	140	2161300005
140	200	140	2161400005
150	225	160	2161500005
160	225	160	2161600005
180	250	155	2161800005
200	300	195	2162000005
225	300	195	2162200005
250	350	205	2162500005
300	400	215	2163000005
350	450	240	2163500005
400	500	240	2164000005
450	550	245	2164500005
500	600	245	2165000005

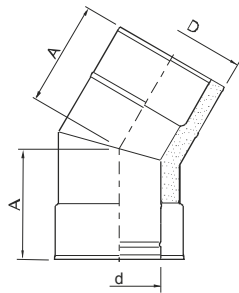

KOLANO 45°

217

d	D	A	INDEX
120	200	125	2171200005
130	200	125	2171300005
140	200	125	2171400005
150	225	130	2171500005
160	225	130	2171600005
180	250	135	2171800005
200	300	160	2172000005
225	300	160	2172200005
250	350	170	2172500005
300	400	180	2173000005
350	450	190	2173500005
400	500	200	2174000005
450	550	210	2174500005
500	600	220	2175000005

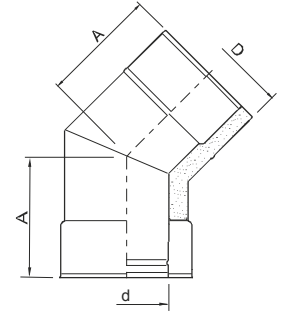

KOLANO 60°

250

d	D	A	INDEX
120	200	140	2501200005
130	200	140	2501300005
140	200	140	2501400005
150	225	160	2501500005
160	225	160	2501600005
180	250	170	2501800005
200	300	195	2502000005
225	300	195	2502200005
250	350	205	2502500005
300	400	215	2503000005
350	450	240	2503500005
400	500	240	2504000005
450	550	245	2504500005
500	600	245	2505000005

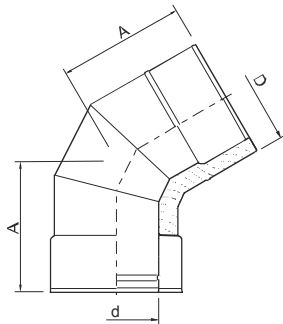

KOLANO 93°

218

d	D	A	INDEX
120	200	155	2181200005
130	200	155	2181300005
140	200	155	2181400005
150	225	165	2181500005
160	225	165	2181600005
180	250	180	2181800005
200	300	220	2182000005
225	300	220	2182200005
250	350	250	2182500005
300	400	280	2183000005
350	450	305	2183500005
400	500	325	2184000005
450	550	355	2184500005
500	600	380	2185000005

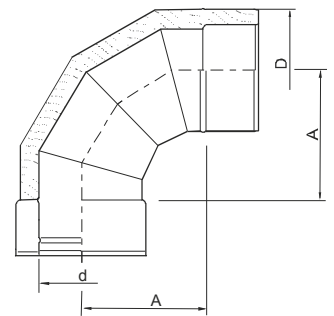

KOLANO Z WYCZYSTKĄ PROSTOKĄTNĄ

219

d	D	A	INDEX
120	200	280	2191200005
130	200	280	2191300005
140	200	280	2191400005
150	225	265	2191500005
160	225	265	2191600005
180	250	255	2191800005
200	300	265	2192000005
225	300	265	2192200005
250	350	255	2192500005
300	400	285	2193000005
350	450	300	2193500005
400	500	365	2194000005
450	550	380	2194500005
500	600	400	2195000005

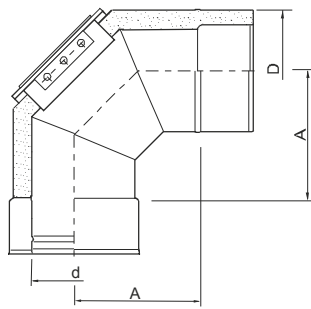

KOLANO Z WYCZYSTKĄ OKRĄGLĄ

220

d1	d	D	A	INDEX
120	120	200	200	2201200005
130	200	200	200	2201300005
140	200	200	200	2201400005
150	225	200	200	2201500005
160	225	200	200	2201600005
180	250	205	200	2201800005
200	300	215	200	2202000005
225	300	215	200	2202200005
250	350	255	200	2202500005
300	400	295	200	2203000005
350	450	300	200	2203500005
400	500	340	200	2204000005
450	550	360	200	2204500005
500	600	390	200	2205000005

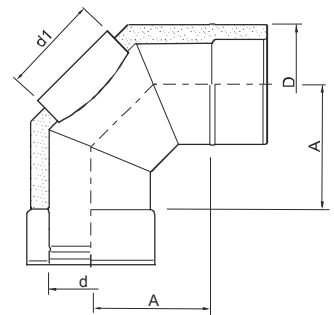

TELESKOP

221

d	D	INDEX
120	200	2211200005
130	200	2211300005
140	200	2211400005
150	225	2211500005
160	225	2211600005
180	250	2211800005
200	300	2212000005
225	300	2212200005
250	350	2212500005
300	400	2213000005
350	450	2213500005
400	500	2214000005
450	550	2214500005
500	600	2215000005

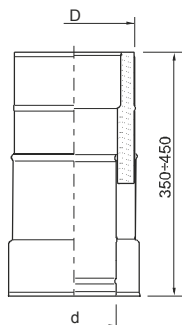

KRÓCIEC POMIAROWY 25

222

d	D	INDEX
120	200	2221200005
130	200	2221300005
140	200	2221400005
150	225	2221500005
160	225	2221600005
180	250	2221800005
200	300	2222000005
225	300	2222200005
250	350	2222500005
300	400	2223000005
350	450	2223500005
400	500	2224000005
450	550	2224500005
500	600	2225000005

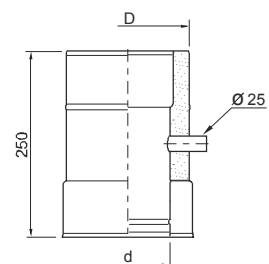

D
W
W

KRÓCIEC POMIAROWY 64 223

d	D	INDEX
120	200	2231200005
130	200	2231300005
140	200	2231400005
150	225	2231500005
160	225	2231600005
180	250	2231800005
200	300	2232000005
225	300	2232200005
250	350	2232500005
300	400	2233000005
350	450	2233500005
400	500	2234000005
450	550	2234500005
500	600	2235000005

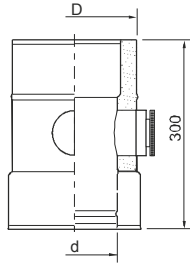

PODPORA PRZEJŚCIOWA 224

d	D	A	INDEX
120	200	300	2241200005
130	200	300	2241300005
140	200	300	2241400005
150	225	300	2241500005
160	225	300	2241600005
180	250	D+100	2241800005
200	300	D+100	2242000005
225	300	D+100	2242200005
250	350	D+100	2242500005
300	400	D+100	2243000005
350	450	D+100	2243500005
400	500	D+100	2244000005
450	550	D+100	2244500005
500	600	D+100	2245000005

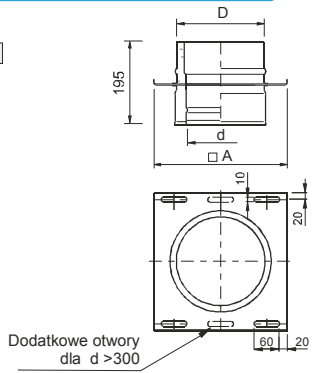

WSPORNIK typ 1 225

D	C	A	INDEX
200	460	320	2252000005
225	460	320	2252200005
250	560	420	2252500005
300	610	500	2253000005
350	720	580	2253500005
400	800	660	2254000005
450	880	740	2254500005
500	960	820	2255000005
550	1040	900	2255500005
600	1120	980	2256000005

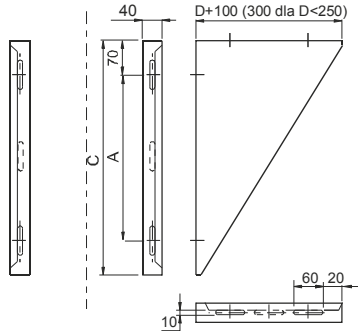

OBEJMA KONSTRUKCYJNA 226

D	INDEX
180	226180Y005
200	226200Y005
225	226220Y005
250	226250Y005
270	226270Y005
300	226300Y005
350	226350Y005
400	226400Y005
450	226450Y005
500	226500Y005
550	226550Y005
600	226600Y005

Y	0	1	2
L	50+100	100+200	200+300

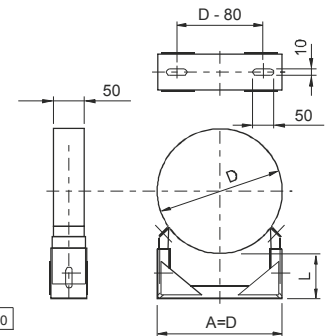

WSPORNIK typ 2 225

D	L	INDEX
250	300	2252501005
300	335	2253001005
350	370	2253501005
400	395	2254001005
450	425	2254501005
500	475	2255001005
550	525	2255501005
600	575	2256001005

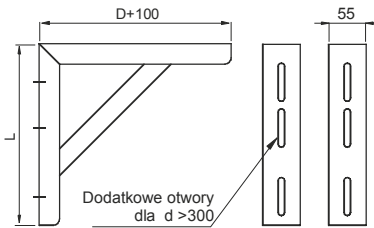

OBEJMA WZMOCNIONA 227

D	INDEX
160	2271600005
180	2271800005
200	2272000005
225	2272200005
250	2272500005
270	2272700005
300	2273000005
350	2273500005
400	2274000005
450	2274500005
500	2275000005
550	2275500005
600	2276000005

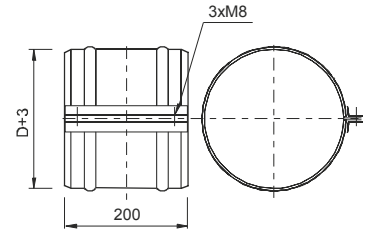

OBEJMA do odcięgów 229

D	INDEX
100	2291000005
110	2291100005
125	2291200005
150	2291500005
160	2291600005
180	2291800005
200	2292000005
225	2292200005
250	2292500005
270	2292700005
300	2293000005
350	2293500005
400	2294000005
450	2294500005
500	2295000005
550	2295500005
600	2296000005

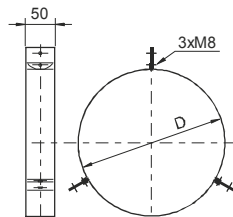

KOŁNIERZ PRZECIWD SZCZOWY 230

D	INDEX
180	2301800005
200	2302000005
225	2302200005
250	2302500005
270	2302700005
300	2303000005
350	2303500005
400	2304000005
450	2304500005
500	2305000005
550	2305500005
600	2306000005

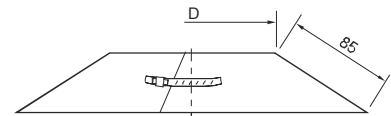

PRZEJŚCIE DACHOWE 0° 231

D	A	INDEX
200	550	2312000005
225	575	2312200005
250	600	2312500005
270	620	2312700005
300	650	2313000005
350	700	2313500005
400	750	2314000005
450	800	2314500005
500	850	2315000005
550	900	2315500005
600	950	2316000005

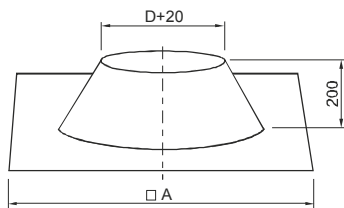

PRZEJŚCIE DACHOWE 15° 232

D	A	B	INDEX
200	560	570	2322000005
225	590	600	2322200005
250	615	625	2322500005
270	635	645	2322700005
300	665	680	2323000005
350	715	730	2323500005
400	765	785	2324000005
450	815	835	2324500005
500	870	890	2325000005
550	920	940	2325500005
600	970	990	2326000005

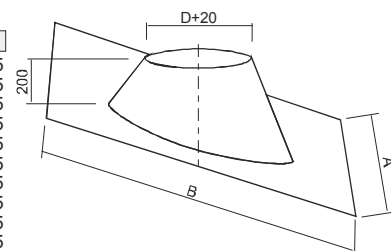

PRZEJŚCIE DACHOWE 30° 233

D	A	B	INDEX
200	570	610	2332000005
225	595	640	2332200005
250	620	670	2332500005
270	620	670	2332700005
300	680	730	2333000005
350	730	790	2333500005
400	780	850	2334000005
450	840	920	2334500005
500	890	970	2335000005
550	940	1035	2335500005
600	990	1095	2336000005

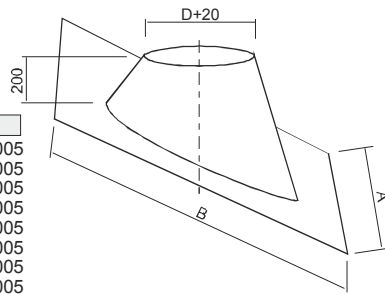

PRZEJŚCIE DACHOWE 45° 234

D	A	B	INDEX
200	580	690	2342000005
225	610	730	2342200005
250	635	770	2342500005
270	635	770	2342700005
300	690	845	2343000005
350	745	920	2343500005
400	805	1000	2344000005
450	850	1075	2344500005
500	910	1150	2345000005
550	960	1230	2345500005
600	1020	1310	2346000005

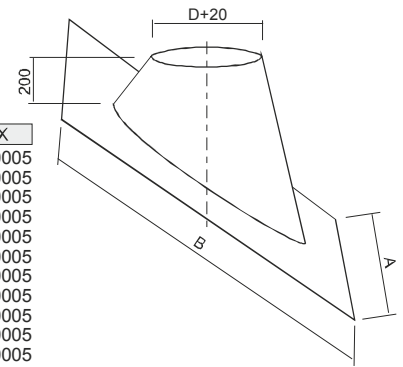

OBEJMA SZEROKA 264

D	INDEX
180	2641800005
200	2642000005
225	2642200005
250	2642500005
270	2642700005
300	2643000005
350	2643500005
400	2644000005
450	2644500005
500	2645000005
550	2645500005
600	2646000005

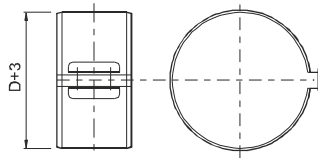

PRZEDŁUŻKA do komina 236

d	D	A	L	INDEX	
120	200	320	1280	780	2361200005
130	200	320	1280	780	2361300005
140	200	320	1280	780	2361400005
150	225	320	1280	780	2361500005
160	225	320	1280	780	2361600005
180	250	400	1280	780	2361800005
200	300	400	1280	780	2362000005
225	300	400	1280	780	2362200005
250	350	450	1280	780	2362500005

Dla L=1280 indeks jest np. 236 120 0005
a dla L=780 indeks jest 236 120 1005

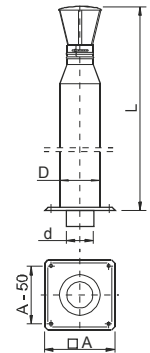

REDUKCJA 237

d	D	INDEX
120	200	237120xyz5
130	200	237130xyz5
140	200	237140xyz5
150	225	237150xyz5
160	225	237160xyz5
180	250	237180xyz5
200	300	237200xyz5
225	300	237220xyz5
250	350	237250xyz5
300	400	237300xyz5
350	450	237350xyz5
400	500	237400xyz5
450	550	237450xyz5
500	600	237500xyz5

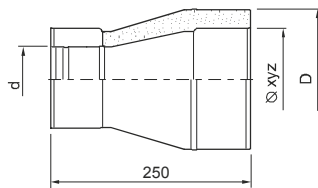

REDUKCJA ODWROTNA 238

d	D	INDEX
120	200	238120xyz5
130	200	238130xyz5
140	200	238140xyz5
150	225	238150xyz5
160	225	238160xyz5
180	250	238180xyz5
200	300	238200xyz5
225	300	238220xyz5
250	350	238250xyz5
300	400	238300xyz5
350	450	238350xyz5
400	500	238400xyz5
450	550	238450xyz5
500	600	238500xyz5

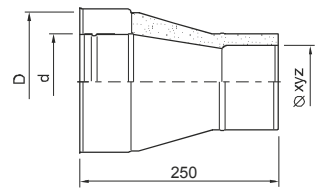

ZŁĄCZKA DWUKIELICHOWA 239

d	D	INDEX
120	200	2391200005
130	200	2391300005
140	200	2391400005
150	225	2391500005
160	225	2391600005
180	250	2391800005
200	300	2392000005
225	300	2392200005
250	350	2392500005
300	400	2393000005
350	450	2393500005
400	500	2394000005
450	550	2394500005
500	600	2395000005

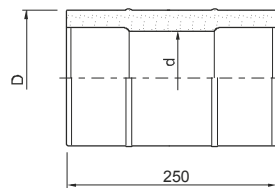

ZŁĄCZKA DWUNYPIŁOWA 240

d	D	INDEX
120	200	2401200005
130	200	2401300005
140	200	2401400005
150	225	2401500005
160	225	2401600005
180	250	2401800005
200	300	2402000005
225	300	2402200005
250	350	2402500005
300	400	2403000005
350	450	2403500005
400	500	2404000005
450	550	2404500005
500	600	2405000005

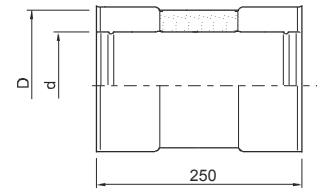

ZAKOŃCZENIE NYPEL-KIELICH 241

d	D	INDEX
120	200	2411200005
130	200	2411300005
140	200	2411400005
150	225	2411500005
160	225	2411600005
180	250	2411800005
200	300	2412000005
225	300	2412200005
250	350	2412500005
300	400	2413000005
350	450	2413500005
400	500	2414000005
450	550	2414500005
500	600	2415000005

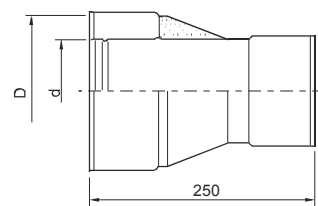

ZAKOŃCZENIE KIELICH-KIELICH 242

d	D	INDEX
120	200	2421200005
130	200	2421300005
140	200	2421400005
150	225	2421500005
160	225	2421600005
180	250	2421800005
200	300	2422000005
225	300	2422200005
250	350	2422500005
300	400	2423000005
350	450	2423500005
400	500	2424000005
450	550	2424500005
500	600	2425000005

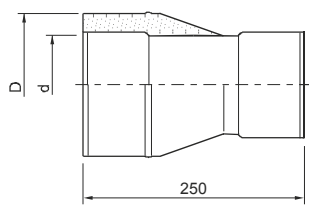

D
W
W

ZAKOŃCZENIE NYPEL-NYPEL 262

d	D	INDEX
120	200	2621200005
130	200	2621300005
140	200	2621400005
150	225	2621500005
160	225	2621600005
180	250	2621800005
200	300	2622000005
225	300	2622200005
250	350	2622500005
300	400	2623000005
350	450	2623500005
400	500	2624000005
450	550	2624500005
500	600	2625000005

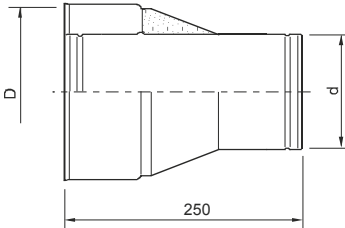

ZAKOŃCZENIE KIELICH-NYPEL 263

d	D	INDEX
120	200	2631200005
130	200	2631300005
140	200	2631400005
150	225	2631500005
160	225	2631600005
180	250	2631800005
200	300	2632000005
225	300	2632200005
250	350	2632500005
300	400	2633000005
350	450	2633500005
400	500	2634000005
450	550	2634500005
500	600	2635000005

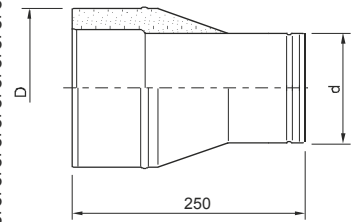

PRZEDŁUŻKA do obejmy konstrukcyjnej 100 243

D	INDEX
160	2431600005
180	2431800005
200	2432000005
225	2432200005
250	2432500005
270	2432700005
300	2433000005
350	2433500005
400	2434000005
450	2434500005
500	2435000005
550	2435500005
600	2436000005

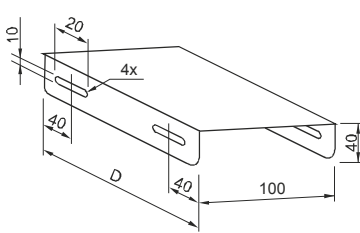

PRZEDŁUŻKA do obejmy konstrukcyjnej 200 244

D	INDEX
160	2441600005
180	2441800005
200	2442000005
225	2442200005
250	2442500005
270	2442700005
300	2443000005
350	2443500005
400	2444000005
450	2444500005
500	2445000005
550	2445500005
600	2446000005

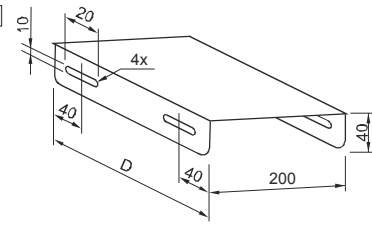

PRZEDŁUŻKA do obejmy konstrukcyjnej 300 245

D	INDEX
160	2451600005
180	2451800005
200	2452000005
225	2452200005
250	2452500005
270	2452700005
300	2453000005
350	2453500005
400	2454000005
450	2454500005
500	2455000005
550	2455500005
600	2456000005

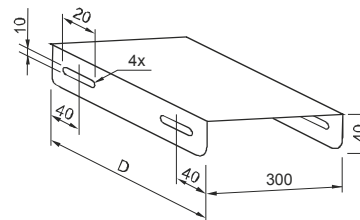

NEUTRALIZATOR 247

Szczegółowy opis na str 89

Typ	Moc (KW)	H	D	INDEX
SPU-0	1-30	180	225	2472200005
SPU-1	31-50	205	300	2473000005
SPU-2	51-100	260	350	2473500005
SPU-3	101-300	340	400	2474000005
SPU-4	301-600	430	600	2476000005

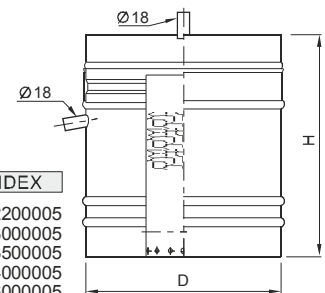

PRZEJŚCIE STROPOWE 260

D	INDEX
200	2602000005
225	2602200005
250	2602500005
270	2602700005
300	2603000005
350	2603500005
400	2604000005
450	2604500005
500	2605000005
550	2605500005
600	2606000005

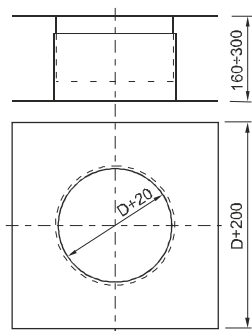

OSŁONA 261

D	INDEX
180	2611800005
200	2612000005
225	2612200005
250	2612500005
270	2612700005
300	2613000005
350	2613500005
400	2614000005
450	2614500005
500	2615000005
550	2615500005
600	2616000005

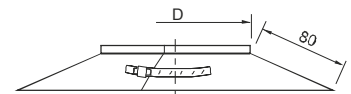

PODSTAWA pod odkraplacz 254

d	A	B	INDEX
120	375	2541300005	
130	375	2541300005	
140	375	2541300005	
150	375	2541300005	
160	375	2541300005	
180	425	2541800005	
200	475	2542000005	
225	475	2542000005	
250	525	2542500005	
300	575	2543000005	
350	625	2543500005	
400	675	2544000005	
450	725	2544500005	
500	775	2545000005	

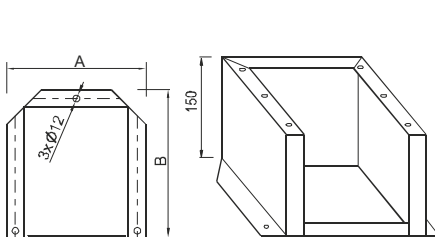

PODSTAWA pod odkraplacz REGULOWANA 255

d	A	B	INDEX
120	375	2551300005	
130	375	2551300005	
140	375	2551300005	
150	375	2551300005	
160	375	2551300005	
180	425	2551800005	
200	475	2552000005	
225	475	2552000005	
250	525	2552500005	
300	575	2553000005	
350	625	2553500005	
400	675	2554000005	
450	725	2554500005	
500	775	2555000005	

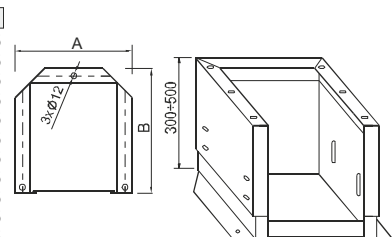

PRZEJŚCIE DACHOWE 0° Pb 249

D	A	INDEX
200	700	2492000005
225	700	2492200005
250	700	2492500005
270	700	2492700005
300	800	2493000005
350	800	2493500005
400	900	2494000005
450	900	2494500005
500	1000	2495000005
550	1000	2495500005
600	1000	2496000005

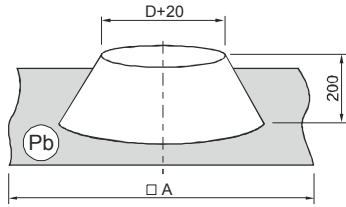

PRZEJŚCIE DACHOWE 15° Pb 253

D	A	INDEX
200	700	2532000005
225	700	2532200005
250	700	2532500005
270	700	2532700005
300	800	2533000005
350	800	2533500005
400	900	2534000005
450	900	2534500005
500	1000	2535000005
550	1000	2535500005
600	1000	2536000005

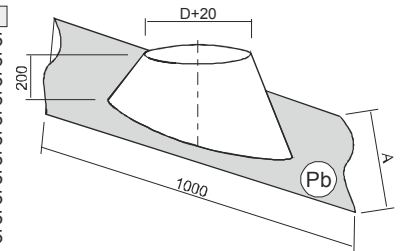

PRZEJŚCIE DACHOWE 30° Pb 251

D	A	INDEX
200	700	2512000005
225	700	2512200005
250	800	2512500005
270	800	2512700005
300	800	2513000005
350	900	2513500005
400	900	2514000005
450	1000	2514500005
500	1000	2515000005
550	1000	2515500005
600	1000	2516000005

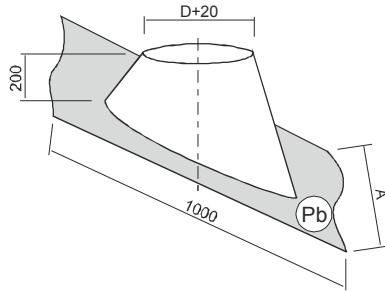

PRZEJŚCIE DACHOWE 45° Pb 252

D	A	B	INDEX
200	700	1000	2522000005
225	800	1000	2522200005
250	800	1000	2522500005
270	800	1000	2522700005
300	800	1000	2523000005
350	1000	1000	2523500005
400	1000	1000	2524000005
450	1000	1000	2524500005
500	1200	1200	2525000005
550	1200	1200	2525500005
600	1200	1200	2526000005

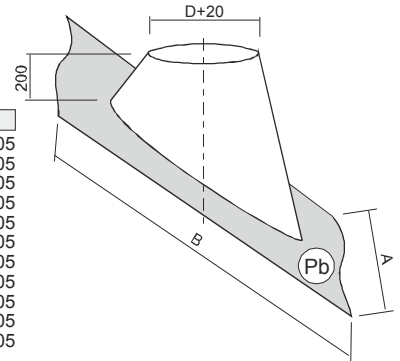

OBEJMA MOCUJĄCA 269

D	INDEX
200	2692000005
225	2692200005
250	2692500005
270	2692700005
300	2693000005
350	2693500005

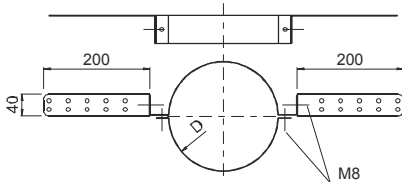

TRÓJNIK REDUKCYJNY 90° 256

d	D	d1	L	INDEX
120	200	400	256120xyz5	
130	200	400	256130xyz5	
140	200	400	256140xyz5	
150	225	450	256150xyz5	
160	225	450	256160xyz5	
180	250	450	256180xyz5	
200	300	500	256200xyz5	
225	300	500	256220xyz5	
250	350	550	256250xyz5	
300	400	600	256300xyz5	
350	450	650	256350xyz5	
400	500	700	256400xyz5	
450	550	750	256450xyz5	
500	600	800	256500xyz5	

Zgodnie z zamówieniem

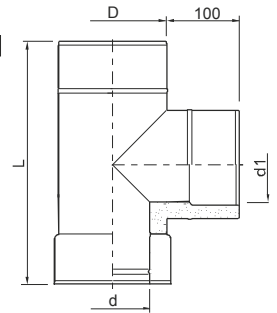

TRÓJNIK REDUKCYJNY 45° 259

d	D	d1	A	L	INDEX
120	200	350	500	259120xyz5	
130	200	350	500	259130xyz5	
140	200	350	500	259140xyz5	
150	225	400	570	259150xyz5	
160	225	400	570	259160xyz5	
180	250	410	570	259180xyz5	
200	300	500	700	259200xyz5	
225	300	500	700	259220xyz5	
250	350	550	800	259250xyz5	
300	400	600	800	259300xyz5	
350	450	680	900	259350xyz5	
400	500	780	1000	259400xyz5	
450	550	780	1000	259450xyz5	
500	600	860	1100	259500xyz5	

Zgodnie z zamówieniem

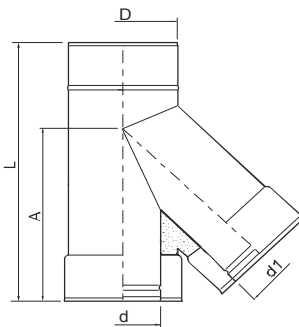

ODSKRAPLACZ z PODSTAWKĄ 248

d	D	A	INDEX
120	200	300	2481201005
130	200	300	2481301005
140	200	300	2481401005
150	225	300	2481501005
160	225	300	2481601005
180	250	330	2481801005
200	300	380	2482001005
225	300	380	2482201005
250	350	430	2482501005

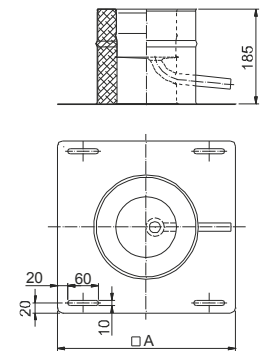

OBEJMA do stropu 229

D	INDEX	D	INDEX
80	2290801005	225	2292201005
100	2291001005	250	2292501005
113	2291101005	270	2292701005
120	2291201005	300	2293001005
130	2291301005	350	2293501005
140	2291401005	400	2294001005
150	2291501005	450	2294501005
160	2291601005	500	2295001005
180	2291801005	550	2295501005
200	2292001005	600	2296001005

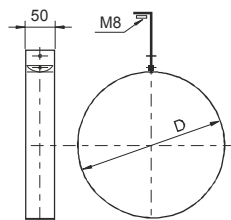

ZATYCZKA PERFOROWANA 298

d	D	INDEX
120	200	2981201005
130	200	2981301005
140	200	2981401005
150	225	2981501005
160	225	2981601005
180	250	2981801005
200	300	2982001005
225	300	2982201005
250	350	2982501005
300	400	2983001005
350	450	2983501005
400	500	2984001005
450	550	2984501005
500	600	2985001005

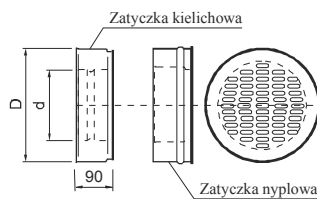

OSŁONA IZOLACJI 296, 297

d	D	INDEX
120	180	29...1201805
120	200	29...1202005
130	180	29...1301805
130	200	29...1302005
130	225	29...1302255
140	180	29...1401805
140	200	29...1402005
150	200	29...1502005
150	225	29...1502255
150	250	29...1502505
160	200	29...1602005
160	225	29...1602255
160	250	29...1602505
180	225	29...1802255
180	250	29...1802505
180	270	29...1802705
200	250	29...2002505
200	300	29...2003005
225	270	29...2202705
225	300	29...2203005
250	300	29...2503005
250	350	29...2503505

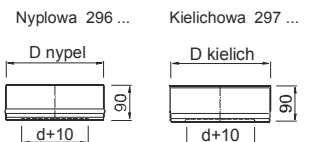

d	D	INDEX
300	350	29...3003505
300	400	29...3004005
350	400	29...3504005
350	450	29...3504505
400	450	29...4004505
400	500	29...4005005
450	500	29...4505005
450	550	29...4505505
500	550	29...5005505
500	600	29...5006005

ZAKOŃCZENIE REDUKCYJNE KIELICH-NYPEL 291

d	D	INDEX
120	200	291120xyz5
130	200	291130xyz5
140	200	291140xyz5
150	225	291150xyz5
160	225	291160xyz5
180	250	291180xyz5
200	300	291200xyz5
225	300	291220xyz5
250	350	291250xyz5
300	400	291300xyz5
350	450	291350xyz5
400	500	291400xyz5
450	550	291450xyz5
500	600	291500xyz5

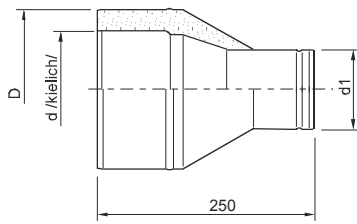

xyz /d1/ - średnica zgodnie z zamówieniem

ZAKOŃCZENIE REDUKCYJNE NYPEL-KIELICH 293

d	D	INDEX
120	200	293120xyz5
130	200	293130xyz5
140	200	293140xyz5
150	225	293150xyz5
160	225	293160xyz5
180	250	293180xyz5
200	300	293200xyz5
225	300	293220xyz5
250	350	293250xyz5
300	400	293300xyz5
350	450	293350xyz5
400	500	293400xyz5
450	550	293450xyz5
500	600	293500xyz5

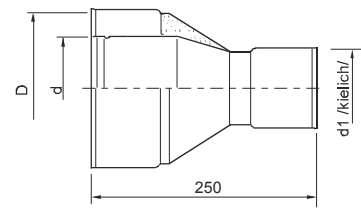

xyz /d1/ - średnica zgodnie z zamówieniem

ZAKOŃCZENIE REDUKCYJNE KIELICH-KIELICH 292

d	D	INDEX
120	200	292120xyz5
130	200	292130xyz5
140	200	292140xyz5
150	225	292150xyz5
160	225	292160xyz5
180	250	292180xyz5
200	300	292200xyz5
225	300	292220xyz5
250	350	292250xyz5
300	400	292300xyz5
350	450	292350xyz5
400	500	292400xyz5
450	550	292450xyz5
500	600	292500xyz5

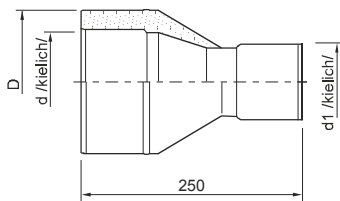

xyz /d1/ - średnica zgodnie z zamówieniem

ZAKOŃCZENIE REDUKCYJNE NYPEL-NYPEL 294

d	D	INDEX
120	200	294120xyz5
130	200	294130xyz5
140	200	294140xyz5
150	225	294150xyz5
160	225	294160xyz5
180	250	294180xyz5
200	300	294200xyz5
225	300	294220xyz5
250	350	294250xyz5
300	400	294300xyz5
350	450	294350xyz5
400	500	294400xyz5
450	550	294450xyz5
500	600	294500xyz5

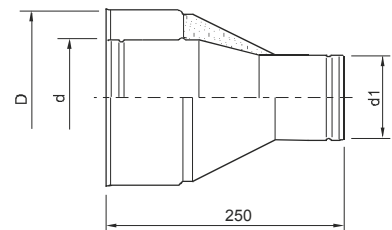

xyz /d1/ - średnica zgodnie z zamówieniem

TRÓJNIK 90° Z WYCZYSTKĄ 208

d	D	L	INDEX
120	200	500	2081200005
130	200	500	2081300005
140	200	500	2081400005
150	225	500	2081500005
160	225	500	2081600005
180	250	500	2081800005
200	300	500	2082000005
225	300	500	2082200005
250	350	550	2082500005
300	400	600	2083000005
350	450	650	2083500005
400	500	700	2084000005
450	550	750	2084500005
500	600	800	2085000005

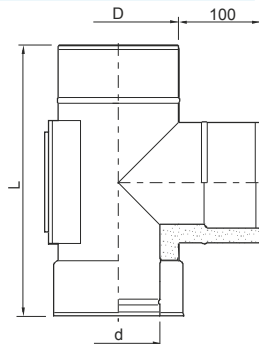

Rura dystansowa 256

d	D	INDEX	
		L=500	L=1000
120	200	2561200005	2561201005
130	200	2561300005	2561301005
140	200	2561400005	2561401005
150	225	2561500005	2561501005
160	225	2561600005	2561601005
180	250	2561800005	2561801005
200	300	2562000005	2562001005
225	300	2562200005	2562201005
250	350	2562500005	2562501005
300	400	2563000005	2563001005
350	450	2563500005	2563501005
400	500	2564000005	2564001005
450	550	2564500005	2564501005
500	600	2565000005	2565001005

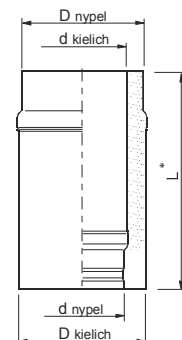

* - długość dopasować przycinając odpowiednio rurę wew. i zew.

TRÓJNIK 45° z WYCZYSTKĄ 266

d	D	A	L	INDEX
120	200	350	500	2661200005
130	200	350	500	2661300005
140	200	350	500	2661400005
150	225	400	570	2661500005
160	225	400	570	2661600005
180	250	410	570	2661800005
200	300	500	700	2662000005
225	300	500	700	2662200005
250	350	550	800	2662500005
300	400	600	800	2663000005
350	450	680	900	2663500005
400	500	780	1000	2664000005
450	550	780	1000	2664500005
500	600	860	1100	2665000005

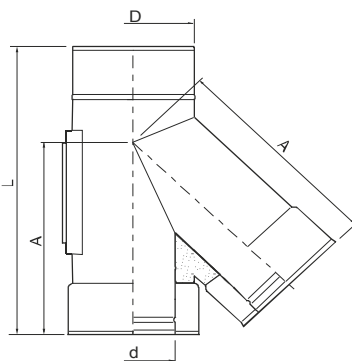

PODPÓRKA POD CZOPUCH 295

D	INDEX
80+550	295000105
600	295000205

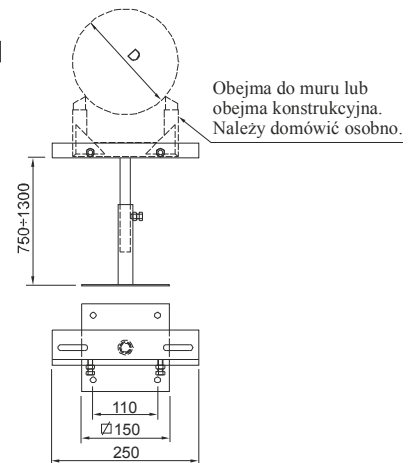

Obejma do muru lub obejma konstrukcyjna. Należy domówić osobno.

ELEMENT NIETYPOWY

999

Elementy niekatalogowe wykonywane są na podstawie rysunków dostarczonych przez klienta. Wycena takich elementów jest oparta na indywidualnej kalkulacji.

Waga wyrobów DWW (przybliżona w kg/szt.)

	INDEX	130/200	140/200	150/225	160/225	180/250	200/300	225/300	250/350	300/400	350/450	400/500	450/550	500/600
ustnik	201	1,2	1,2	1,3	1,4	1,5	1,8	1,9	2,2	2,5	2,9	3,2	3,6	3,9
ustnik pod parasol	202	1,3	1,3	1,5	1,5	1,7	2,0	2,1	2,4	2,8	3,2	3,6	4,0	4,4
rura 1000	203	6,1	6,6	6,9	7,3	7,9	9,4	9,8	11,3	13,1	15,0	16,8	18,7	20,5
rura 500	204	3,2	3,4	3,7	3,8	4,1	4,9	5,1	5,8	6,7	7,6	8,6	9,5	10,4
rura 330	205	2,4	2,2	2,6	2,6	2,8	3,4	3,5	3,9	4,6	5,2	5,8	6,4	7,0
rura 250	206	1,7	1,8	2,0	2,0	2,2	2,6	2,7	3,0	3,5	4,0	4,4	5,9	6,8
trójnik 90°	207	2,7	2,8	3,6	3,7	4,2	4,5	5,9	6,7	8,8	10,7	14,8	17,4	20,2
trójnik 45°	209	5,3	5,5	6,3	6,5	7,3	9,8	11,7	15,9	19,1	24,6	31,1	34,6	41,8
trójnik pod regulator ciągu	210	3,6	3,8	4,1	4,2	4,7	5,0	5,3	6,0	6,9	7,9	8,9	9,8	10,0
wyczystka	211	3,6	3,7	4,0	4,1	4,5	5,2	5,4	6,1	7,1	8,0	9,0	9,9	10,8
wyczystka okrągła	212	3,7	3,8	3,9	4,2	4,7	5,4	5,7	6,4	7,4	8,4	9,4	10,4	
odskraplacz	214	1,4	1,4	1,4	1,5	2,4	2,9	3,0	4,6	5,6	6,8	8,0	9,4	10,8
kolano 15°	215	2,0	2,1	2,6	2,6	2,8	4,0	4,1	4,9	6,0	7,5	8,4	9,5	10,4
kolano 30°	216	2,0	2,1	2,6	2,6	2,8	4,0	4,1	4,9	6,0	7,5	8,4	9,5	10,4
kolano 45°	217	2,0	2,1	2,4	2,8	2,9	4,0	4,1	5,6	5,8	7,5	8,4	9,3	10,4
kolano 90°	218	3,1	3,2	3,5	3,6	4,7	6,0	6,2	8,0	9,8	12,6	15,5	18,0	18,9
kolano 90° z wyczystką	219	2,8	2,9	3,1	3,2	3,5	4,3	4,5	6,1	8,1	9,4	11,8	13,2	16,4
kolano 90° z wyczystk. okr.	220	2,8	2,9	3,1	3,2	3,5	4,3	4,5	6,1	8,1	9,4	11,8	13,2	16,4
teleskop	221	3,4	3,5	3,6	4,0	4,2	5,2	5,3	6,1	6,9	7,9	8,8	9,8	10,7
króciec pomiarowy 25	222	2,2	2,3	2,6	2,6	3,0	3,7	3,7	4,5	5,4	6,3	7,3	8,3	9,4
króciec pomiarowy 64	223	4,0	4,1	4,2	4,3	4,5	4,8	4,9	5,2	5,7	6,2	6,7	6,8	7,6
podpora przejściowa	224	1,5	1,5	1,6	1,8	2,6	3,2	3,3	4,9	5,9	7,0	8,2	9,5	10,8
wspornik	225	3,4	3,4	3,4	3,4	5,4	5,6	5,6	7,2	8,4	10,0	11,6	13,4	15,6
obejma konstrukcyjna	226	0,7	0,7	0,8	0,8	1,1	1,3	1,3	2,3	2,7	3,1	3,5	3,9	5,6
obejma wzmacniona	227	1,1	1,1	1,2	1,2	1,3	1,5	1,5	1,7	1,9	2,1	2,2	2,4	2,6
obejma szeroka	228	0,4	0,4	0,4	0,4	0,5	0,6	0,6	0,7	0,8	0,8	0,9	1,0	1,1
obejma do odciągów	229						0,2	0,2	0,2	0,2	0,3	0,4	0,4	0,5
kolnierz p. deszczowy	230	0,4	0,4	0,5	0,5	0,5	0,7	0,7	0,9	1,1	1,3	1,5	1,8	2,1
przejście dachowe 0°	231	1,9	1,9	2,0	2,0	2,2	2,6	2,6	3,0	3,4	3,8	4,2	4,7	5,2
przejście dachowe 15°	232	1,9	1,9	2,2	2,2	2,3	2,7	2,7	3,2	3,6	4,2	4,5	5,1	5,6
przejście dachowe 30°	233	2,2	2,2	2,4	2,4	2,7	3,1	3,2	3,6	4,2	4,8	5,3	5,9	6,6
przejście dachowe 45°	234	2,6	2,6	2,9	2,9	3,2	3,7	3,7	4,4	5,1	5,8	6,5	7,3	8,2
tłumik	235	7,0	7,2	7,6	7,9	8,5	9,2	9,9	10,7	12,2	13,9	15,4	17,0	18,5
przedłużka komina	236	6,9	7,1	7,8	8,3	9,4	10,7	13,0						
złączka dwykielichowa	239	2,0	2,1	2,2	2,3	2,5	2,8	3,2	3,3	3,8	4,2	4,7	5,2	5,7
złączka dwunypłowa	240	2,0	2,1	2,2	2,3	2,5	2,8	3,2	3,3	3,8	4,2	4,7	5,2	5,7
złączka SPUX/SPU nypłowa	241	1,5	1,5	1,5	1,7	1,8	2,0	2,1	2,3	2,7	3,1	3,4	3,8	4,2
złączka SPUX/SPU kielichowa	242	1,5	1,5	1,5	1,7	1,8	2,0	2,1	2,3	2,7	3,1	3,4	3,8	4,2
przedłużka do obejmy 100	243	0,4	0,4	0,5	0,5	0,6	0,6	0,6	1,0	1,2	1,3	1,4	1,6	1,7
przedłużka do obejmy 200	244	0,7	0,7	0,8	0,8	0,8	1,0	1,0	1,6	1,8	2,0	2,2	2,5	2,7
przedłużka do obejmy 300	245	1,2	1,2	1,4	1,4	1,5	1,8	1,8	2,1	2,4	2,7	3,0	3,3	3,6
odskraplacz z płytą prostą	248	1,6	1,6	1,6	1,6	2,5	3,2	3,2	3,9	4,8	5,7	6,7	7,7	8,9
podstawa pod odskraplacz	254	3,5	3,5	3,7	3,7	4,1	4,5	4,5	5,1	5,7	6,2	6,7	7,2	7,8
podst. pod odskraplacz reg.	255	10,0	10,0	10,5	11,0	11,5	13,1	13,6	14,6	16,1	17,7	19,2	20,8	22,3
przejście stropowe	260	1,9	1,9	2,1	2,1	2,4	2,9	2,9	3,5	4,1	4,8	5,5	6,3	7,1
Oslona	261	0,4	0,4	0,5	0,5	0,5	0,7	0,7	0,9	1,1	1,3	1,5	1,8	2,1

Dwuścienny system odprowadzania spalin DWW Zalecane wymiary konstrukcyjne

Montaż podpór (dotyczy wsporników typ I i II)
- zalecane odległości w [m]

DN	A	B	C	D
mm	m			
130	22	22	2	1,5
140	22	22	2	1,5
150	21	21	2	1,5
160	21	21	2	1,5
180	20	18	2	1,5
200	19	15	2	1,5
225	19	13	2	1,5
250	18	11	2	1,0
300	17	11	2	1,0
350	16	9	2	1,0
400	16	9	2	1,0
450	16	7	2	1,0
500	16	7	2	1,0

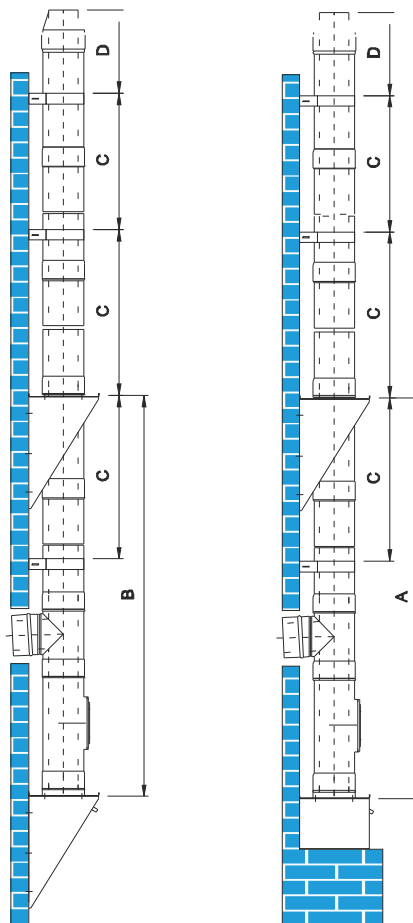

**D
W
W**

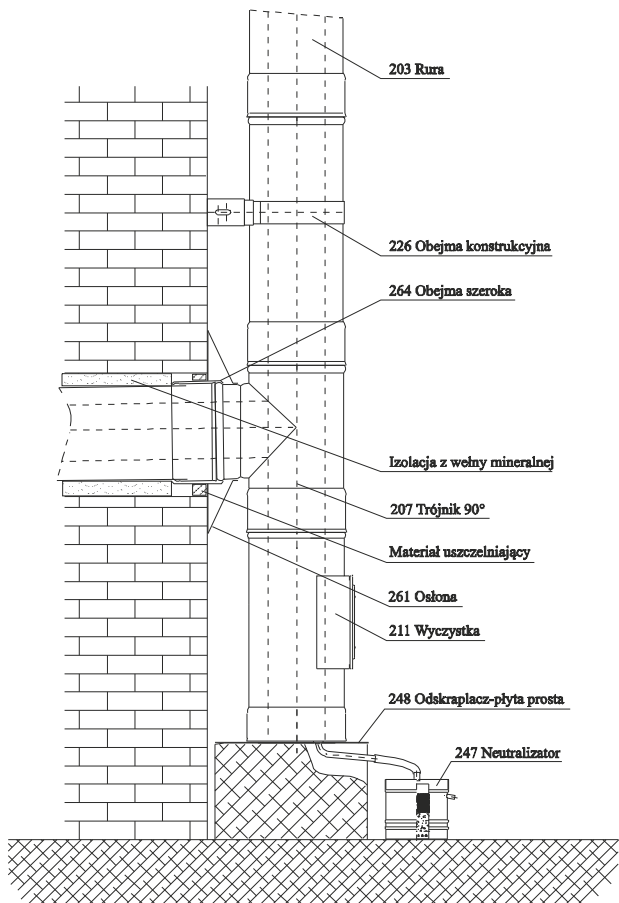

1. Posadowienie komina DWW na fundamencie

D
W
W

2. Montaż komina DWW na wspornikach

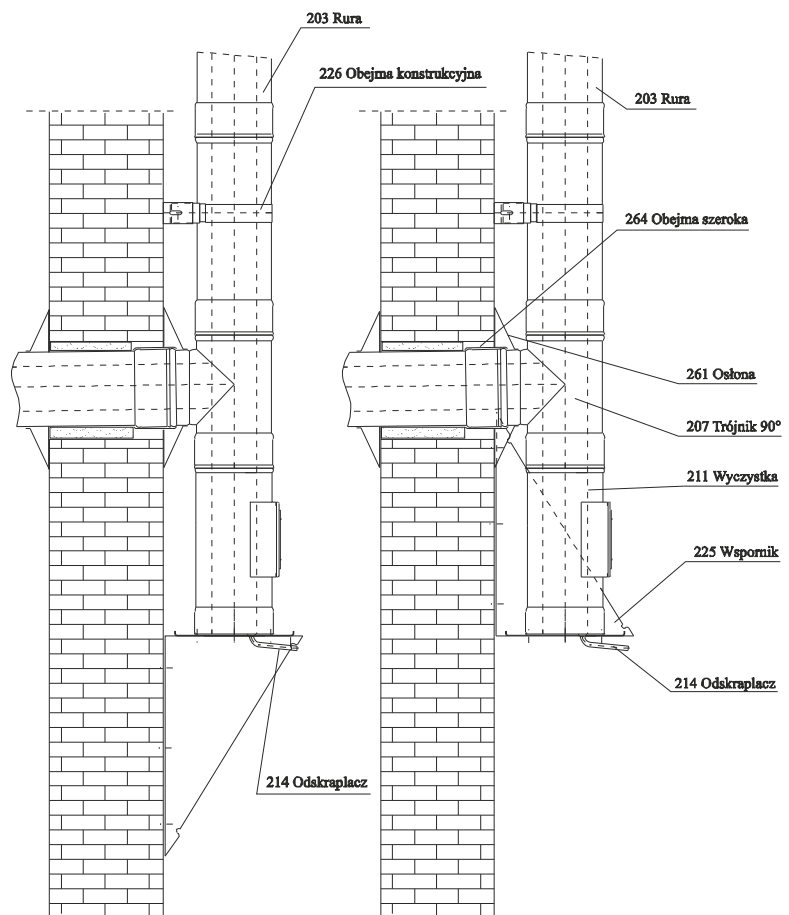

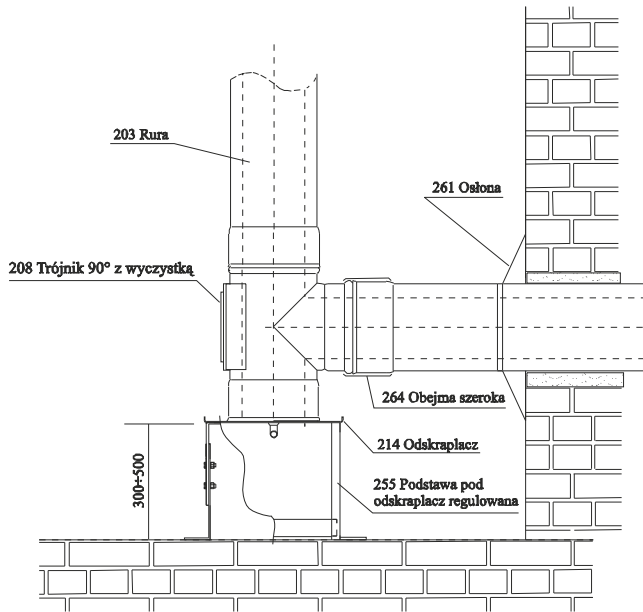

3. Posadowienie komina DWW na podstawie regulowanej przy niewielkiej wysokości nad ziemią

4. Podpora przejściowa DWW

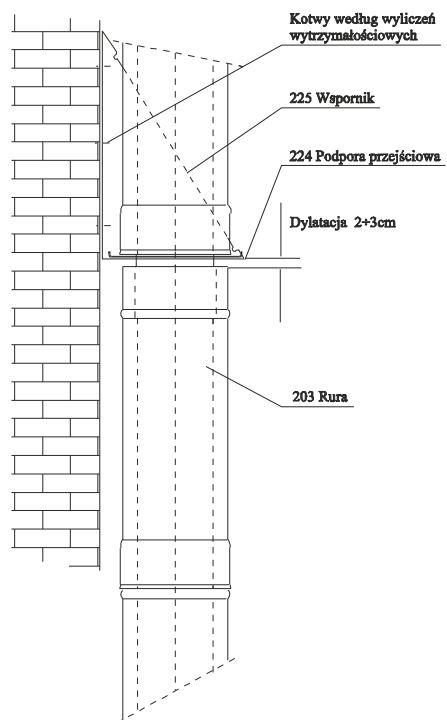

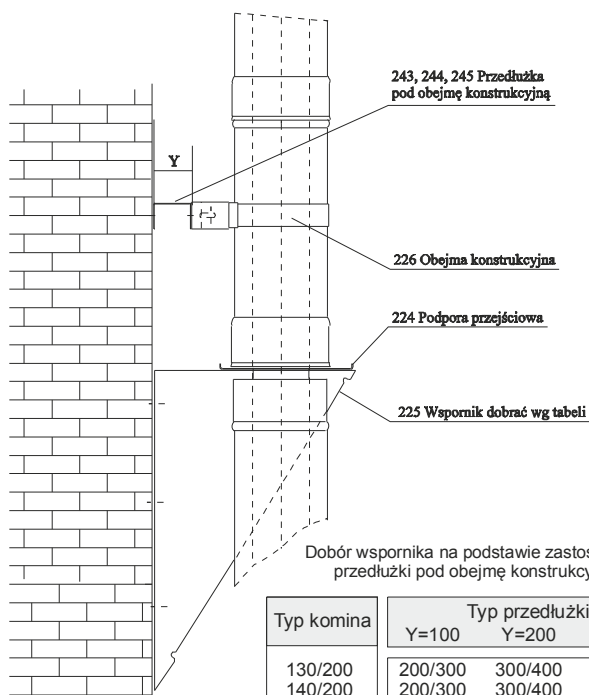

Typ komina	Typ przedłużki			Typ wspornika
	Y=100	Y=200	Y=300	
130/200	200/300	300/400	400/500	
140/200	200/300	300/400	400/500	
150/225	200/300	300/400	400/500	
160/225	200/300	300/400	400/500	
180/250	250/350	350/450	450/550	
200/300	300/400	400/500	500/600	
225/300	300/400	400/500	500/600	
250/350	350/450	450/550		
300/400	400/500	500/600		
350/450	450/550			
400/500	500/600			

5. Dobór wsporników oraz przedłupek obejm konstrukcyjnych

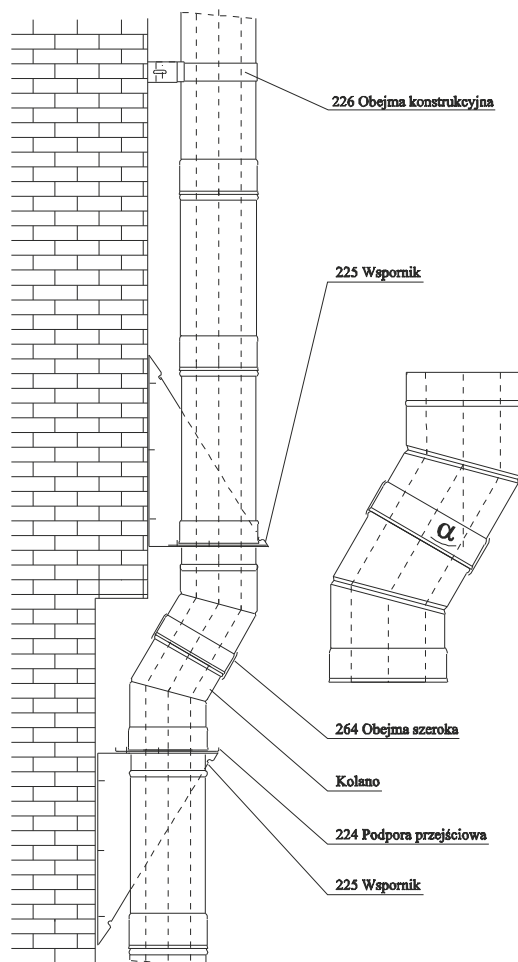

6. Odsadzka komina DWW $\alpha \leq 30^\circ$

Schematy montażowe DWW



Tabela odsadzeń

L= 0

	A	X	Y	A	X	Y	A	X	Y
130/200	140	57	493	140	110	471	125	134	384
150/225	160	67	571	160	130	545	130	141	401
180/250	155	65	551	155	125	527	135	148	418
200/300	195	85	709	195	165	676	160	184	504
250/350	205	91	748	205	175	713	170	198	538
300/400	215	96	787	215	185	750	180	212	572

L= 250

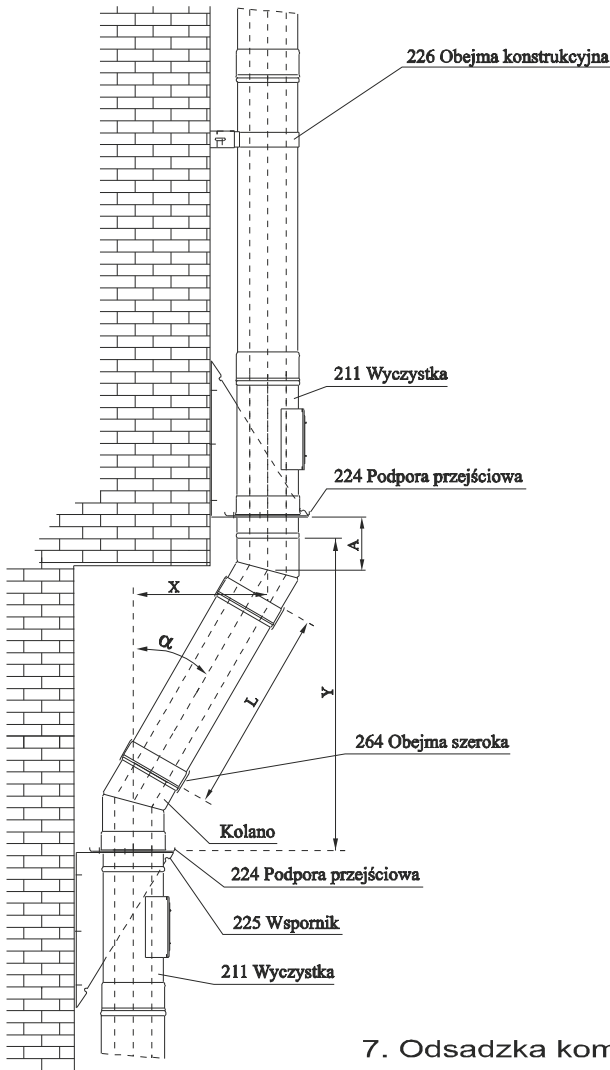
	A	X	Y	A	X	Y	A	X	Y
130/200	140	106	676	140	205	635	125	269	519
150/225	160	116	755	160	225	710	130	276	536
180/250	155	114	735	155	220	691	135	283	553
200/300	195	135	892	195	260	840	160	318	638
250/350	205	140	932	205	270	878	170	332	672
300/400	215	145	971	215	280	915	180	346	706

L= 330

	A	X	Y	A	X	Y	A	X	Y
130/200	140	127	753	140	245	704	125	325	575
150/225	160	137	832	160	265	779	130	332	592
180/250	155	135	812	155	260	760	135	339	609
200/300	195	155	970	195	300	910	160	375	695
250/350	205	160	1009	205	310	947	170	389	729
300/400	215	166	1048	215	320	984	180	403	763

L= 500

	A	X	Y	A	X	Y	A	X	Y
130/200	140	171	918	140	330	852	125	445	695
150/225	160	181	996	160	350	926	130	453	713
180/250	155	179	976	155	345	908	135	460	730
200/300	195	199	1134	195	385	1057	160	495	815
250/350	205	204	1173	205	395	1094	170	509	849
300/400	215	210	1212	215	405	1131	180	523	883

L= 1000

	A	X	Y	A	X	Y	A	X	Y
130/200	140	300	1400	140	580	1285	125	799	1049
150/225	160	311	1479	160	600	1359	130	806	1066
180/250	155	308	1459	155	595	1341	135	813	1083
200/300	195	329	1617	195	635	1490	160	849	1169
250/350	205	334	1656	205	645	1527	170	863	1203
300/400	215	339	1695	215	655	1564	180	877	1237

7. Odsadzka komina DWW $15^\circ < \alpha < 45^\circ$

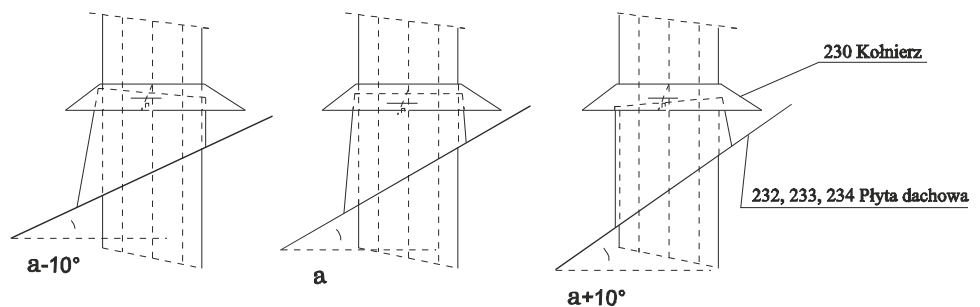

8. Przejście dachowe DWW

Tabela wymiarowa		
Przejście dachowe	Kąt pochylenia płyty	Zakres pochylenia
231 - 0°	0°	0° - 10°
232 - 15°	15°	5° - 25°
233 - 30°	30°	20° - 40°
234 - 45°	45°	35° - 55°

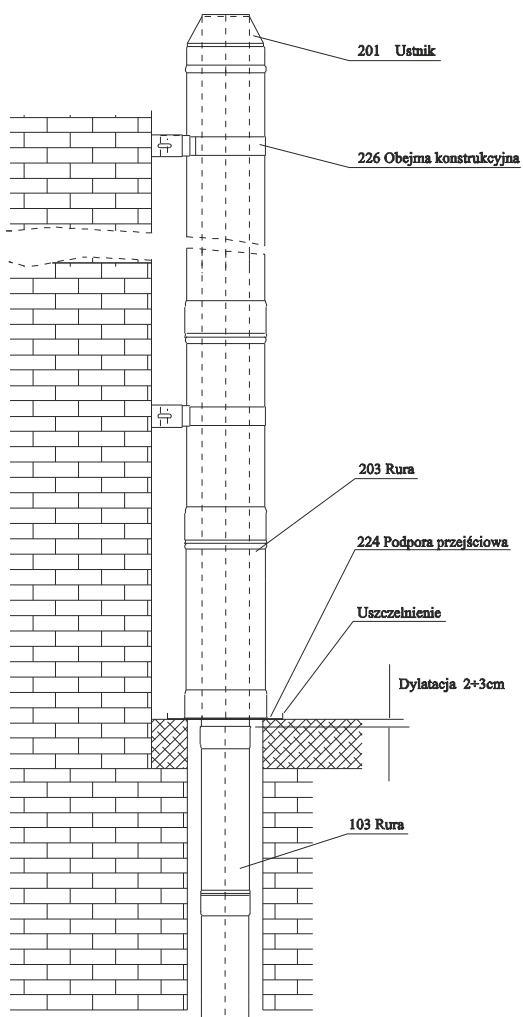

9. Przejście komina jednościennego SPU na dwuścienne DWW

10. Zakończenie komina DWW - do 1.5m

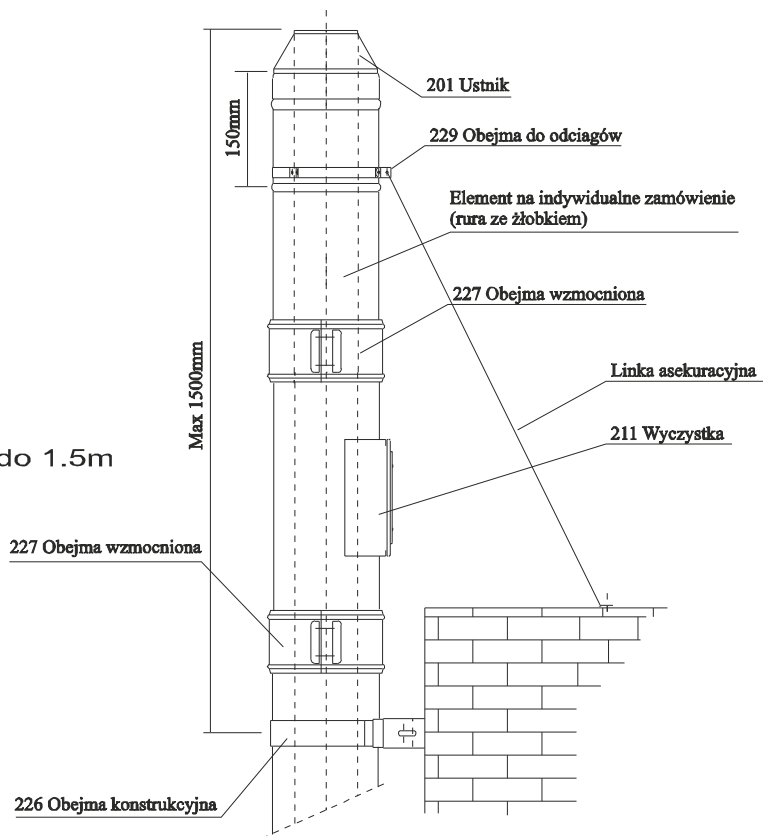

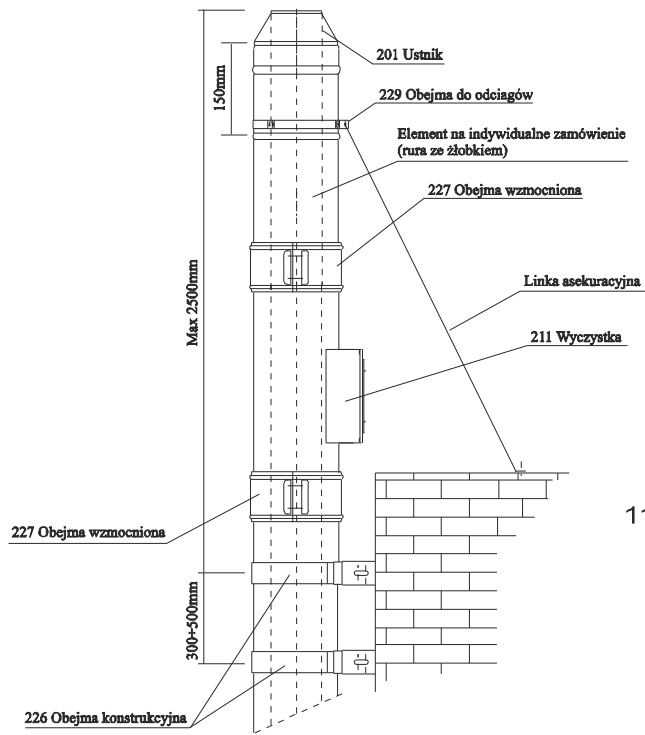

11. Zakończenie komina DWW - do 2.5m

12. Zakończenie komina DWW - ponad 2.5m

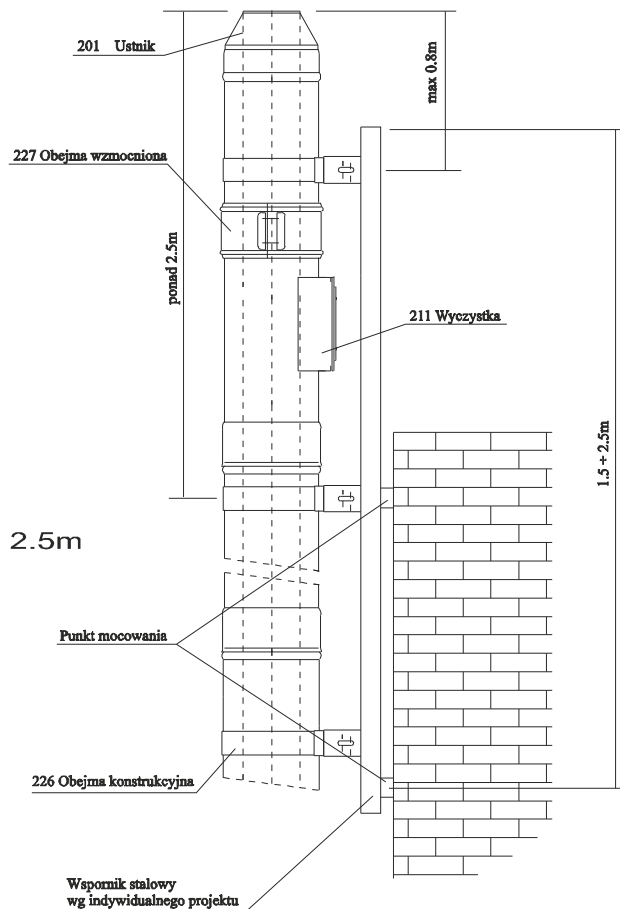

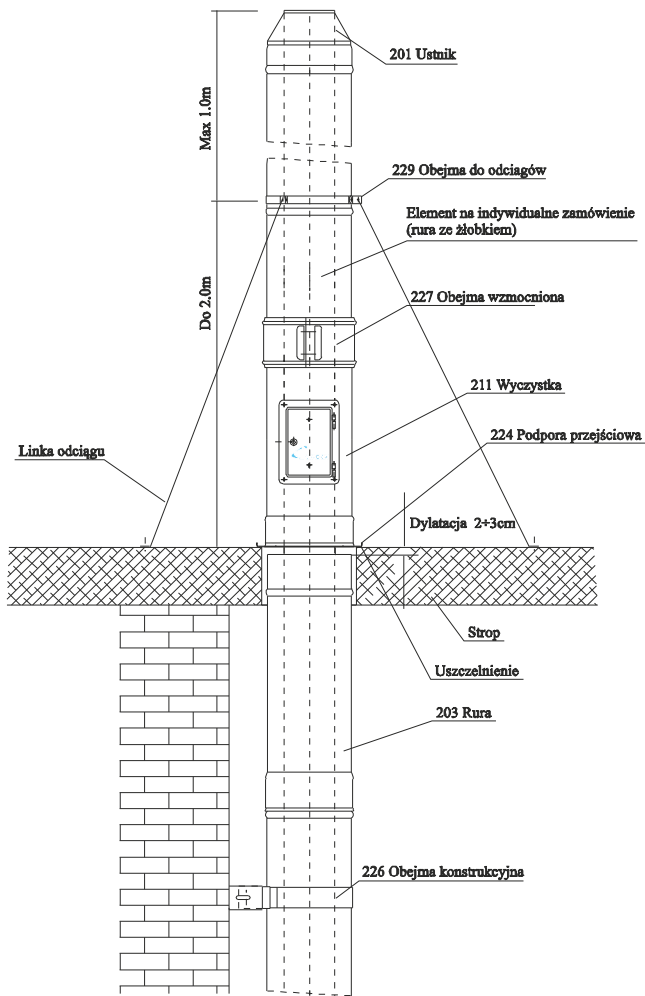

13. Sposób montażu odciągów

D
W
W

14. Przejście stropowe i przejście dachowe DWW

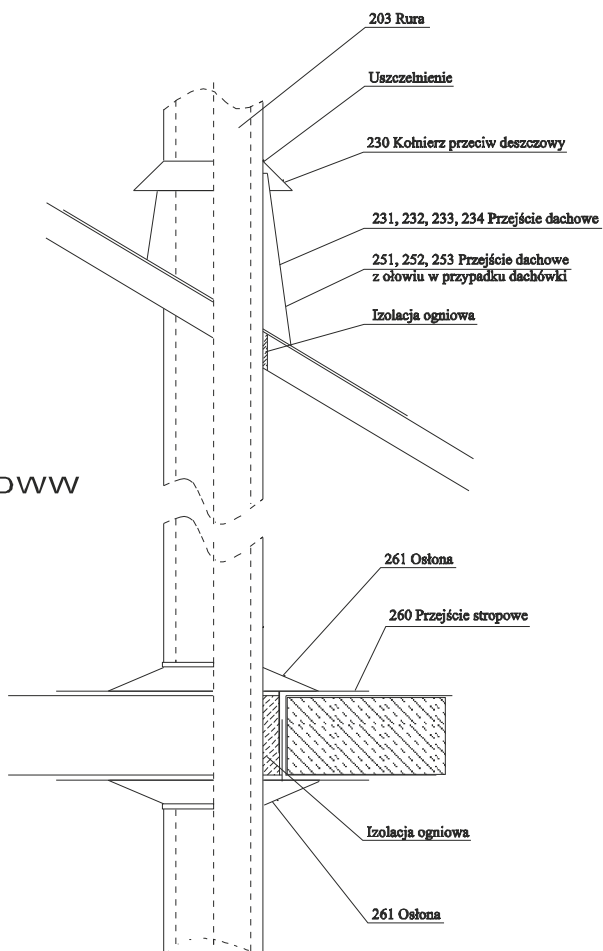

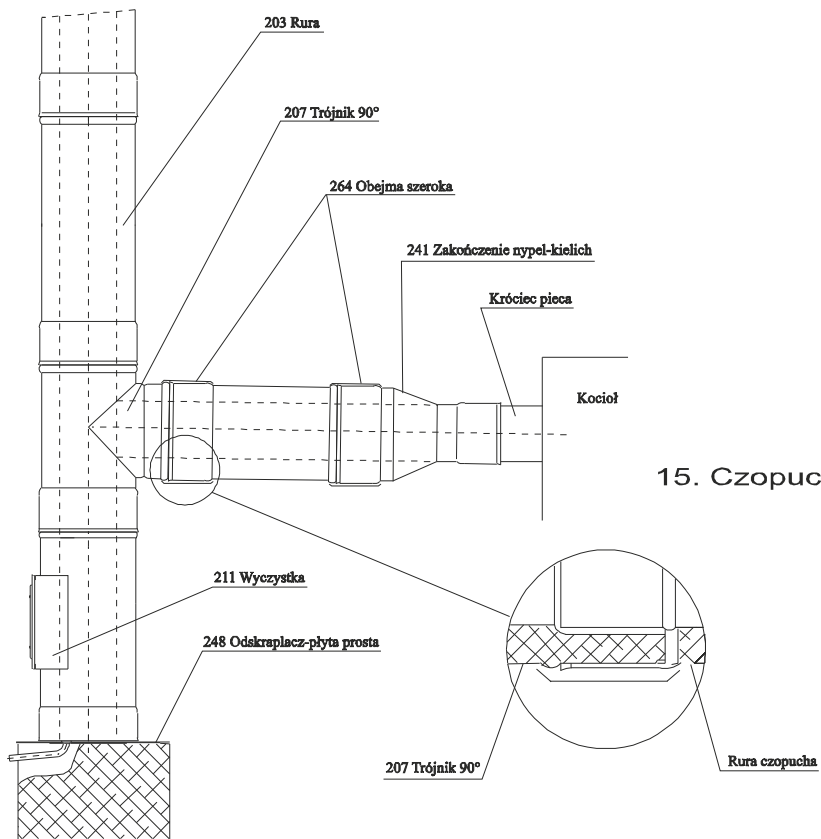

15. Czopuch komina DWW z trójnikiem 90°

16. Czopuch komina DWW z trójnikiem 45°

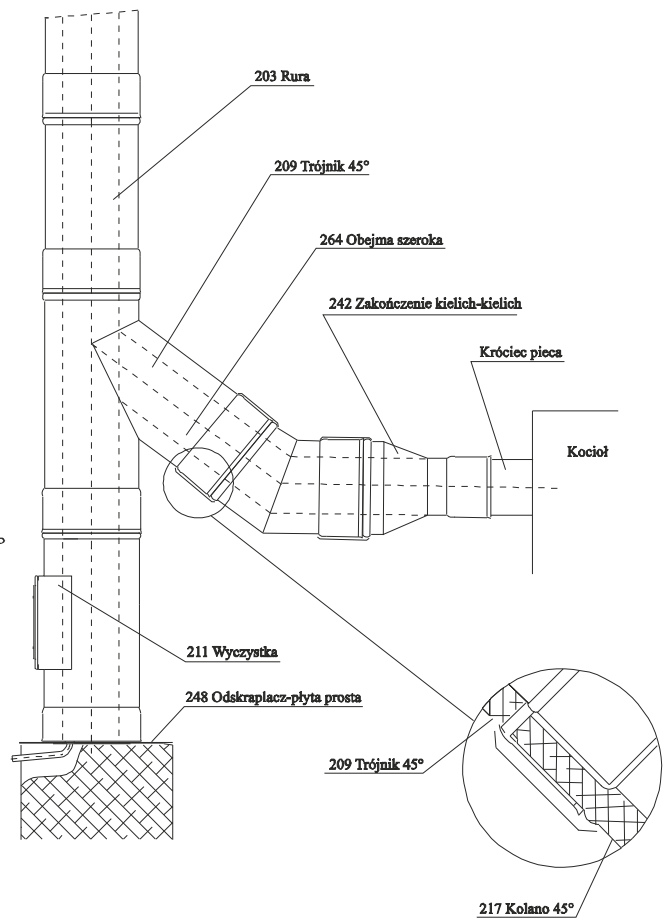

PRZEZNACZENIE:

stosowany jako komin zewnętrzny w celu odprowadzenia spalin na zewnątrz budynku z urządzeń grzewczych opalanych gazem lub olejem opałowym o maksymalnej temperaturze spalin 450 °C

BUDOWA RUR I KSZTAŁTEK:

elementy dwuścienne izolowane wełną mineralną o grubości 20÷30 mm,

ZAKRES ŚREDNIC:

120/180 ÷ 500/550 mm

PALIWO:

gaz lub olej opałowy

GATUNEK I GRUBOŚĆ MATERIAŁ:

stal nierdzewna i kwasoodporna 1.4301 /opcjonalnie 1.4404, 1.4521/ o grubości 0,5÷0,8 mm

ODPORNOŚĆ NA KOROZJĘ:

Vm/V2/V3

ODLEGŁOŚĆ OD MATERIAŁÓW PALNYCH:

150 mm

KLASA TEMPERATURY:

T 450 - 450 °C

SPOSÓB PRACY KOMINA:

podciśnieniowy

ODPORNOŚĆ NADZIAŁANIE KONDENSATU:

D

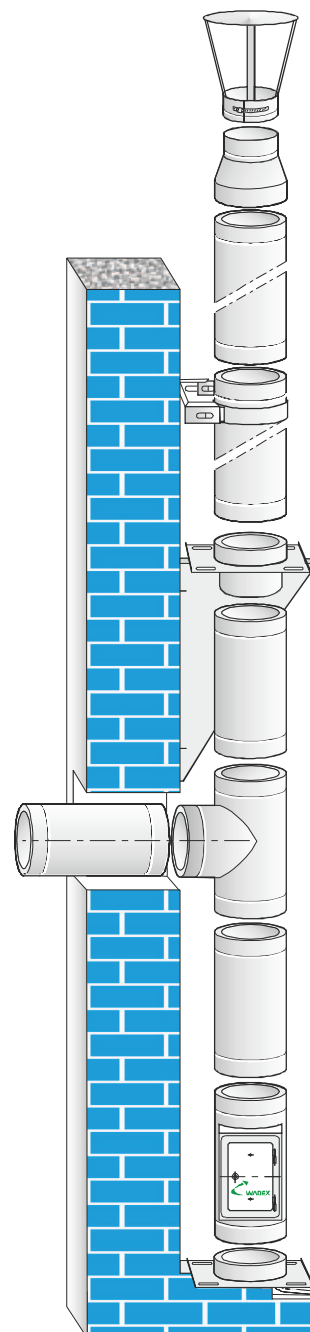

USTNIK invest

201

d	D	INDEX
120	180	2011200007
130	180	2011300007
140	180	2011400007
150	200	2011500007
160	200	2011600007
180	225	2011800007
200	250	2012000007
225	270	2012200007
250	300	2012500007
300	350	2013000007
350	400	2013500007
400	450	2014000007
450	500	2014500007
500	550	2015000007

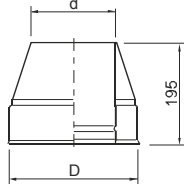

USTNIK POD PARASOL invest

202

d	D	INDEX
120	180	2021200007
130	180	2021300007
140	180	2021400007
150	200	2021500007
160	200	2021600007
180	225	2021800007
200	250	2022000007
225	270	2022200007
250	300	2022500007
300	350	2023000007
350	400	2023500007
400	450	2024000007
450	500	2024500007
500	550	2025000007

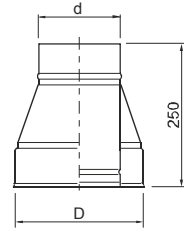

RURA invest 203, 204, 205, 206

		INDEX			
d	D	L1000	L500	L330	L250
120	180	2031200007	2041200007	2051200007	2061200007
130	180	2031300007	2041300007	2051300007	2061300007
140	180	2031400007	2041400007	2051400007	2061400007
150	200	2031500007	2041500007	2051500007	2061500007
160	200	2031600007	2041600007	2051600007	2061600007
180	225	2031800007	2041800007	2051800007	2061800007
200	250	2032000007	2042000007	2052000007	2062000007
225	270	2032200007	2042200007	2052200007	2062200007
250	300	2032500007	2042500007	2052500007	2062500007
300	350	2033000007	2043000007	2053000007	2063000007
350	400	2033500007	2043500007	2053500007	2063500007
400	450	2034000007	2044000007	2054000007	2064000007
450	500	2034500007	2044500007	2054500007	2064500007
500	550	2035000007	2045000007	2055000007	2065000007

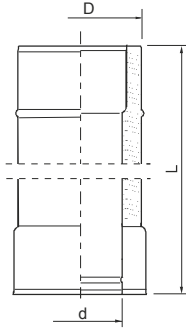

TRÓJNIK 90° invest

207

d	D	L	INDEX
120	180	400	2071200007
130	180	400	2071300007
140	180	400	2071400007
150	200	400	2071500007
160	200	400	2071600007
180	225	450	2071800007
200	250	450	2072000007
225	270	500	2072200007
250	300	500	2072500007
300	350	550	2073000007
350	400	600	2073500007
400	450	650	2074000007
450	500	700	2074500007
500	550	750	2075000007

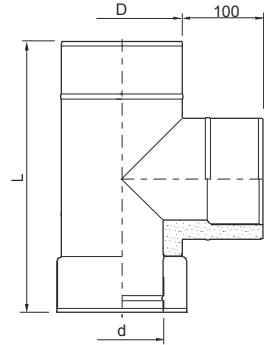

TRÓJNIK 45° invest

209

d	D	A	L	INDEX
120	180	350	500	2091200007
130	180	350	500	2091300007
140	180	350	500	2091400007
150	200	350	500	2091500007
160	200	350	500	2091600007
180	225	400	570	2091800007
200	250	400	570	2092000007
225	270	420	570	2092200007
250	300	500	700	2092500007
300	350	550	800	2093000007
350	400	600	800	2093500007
400	450	680	900	2094000007
450	500	780	1000	2094500007
500	550	760	1000	2095000007

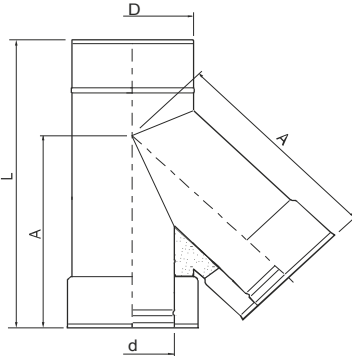

TRÓJNIK POD REGULATOR CIĄGU invest

210

d	D	INDEX
120	180	2101200007
130	180	2101300007
140	180	2101400007
150	200	2101500007
160	200	2101600007
180	225	2101800007
200	250	2102000007
225	270	2102200007
250	300	2102500007
300	350	2103000007
350	400	2103500007
400	450	2104000007
450	500	2104500007
500	550	2105000007

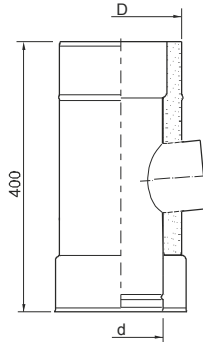

WYCZYSTKA invest

211

d	D	INDEX
120	180	2111200007
130	180	2111300007
140	180	2111400007
150	200	2111500007
160	200	2111600007
180	225	2111800007
200	250	2112000007
225	270	2112200007
250	300	2112500007
300	350	2113000007
350	400	2113500007
400	450	2114000007
450	500	2114500007
500	550	2115000007

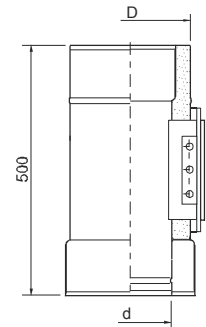

WYCZYSTKA OKRĄGŁA invest

212

d1	d	D	INDEX
120	120	180	2121200007
130	130	180	2121300007
140	140	180	2121400007
150	150	200	2121500007
160	160	200	2121600007
180	180	225	2121800007
200	200	250	2122000007
225	225	270	2122200007
250	250	300	2122500007
300	300	350	2123000007
350	350	400	2123500007
400	400	450	2124000007
450	450	500	2124500007
500	500	550	2125000007

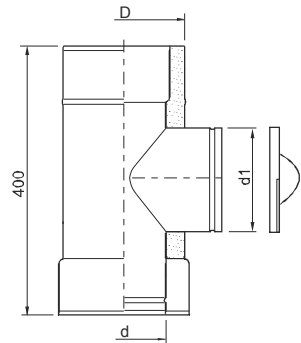

ODSKRAPLACZ invest

214

d	D	A	INDEX
120	180	300	2141200007
130	180	300	2141300007
140	180	300	2141400007
150	200	300	2141500007
160	200	300	2141600007
180	225	300	2141800007
200	250	350	2142000007
225	270	370	2142200007
250	300	400	2142500007
300	350	450	2143000007
350	400	500	2143500007
400	450	550	2144000007
450	500	600	2144500007
500	550	650	2145000007

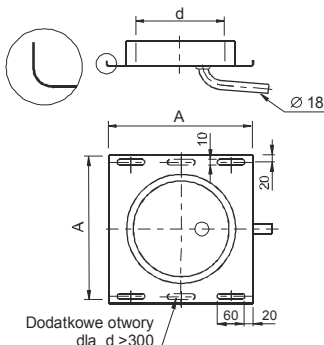

ODSKRAPLACZ - płyta prosta invest 248

d	D	A	INDEX
120	180	300	2481200007
130	180	300	2481300007
140	180	300	2481400007
150	200	300	2481500007
160	200	300	2481600007
180	225	350	2481800007
200	250	400	2482000007
225	270	400	2482200007
250	300	450	2482500007
300	350	500	2483000007
350	400	550	2483500007
400	450	600	2484000007
450	500	650	2484500007
500	550	700	2485000007

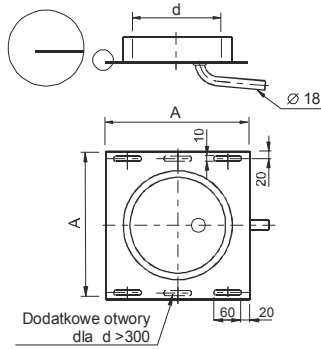

KOLANO 15° invest 215

d	D	A	INDEX
120	180	125	2151200007
130	180	125	2151300007
140	180	125	2151400007
150	200	125	2151500007
160	200	125	2151600007
180	225	130	2151800007
200	250	135	2152000007
225	270	145	2152200007
250	300	160	2152500007
300	350	170	2153000007
350	400	180	2153500007
400	450	190	2154000007
450	500	200	2154500007
500	550	210	2155000007

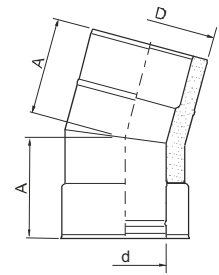

KOLANO 30° invest 216

d	D	A	INDEX
120	180	125	2161200007
130	180	125	2161300007
140	180	125	2161400007
150	200	125	2161500007
160	200	125	2161600007
180	225	130	2161800007
200	250	135	2162000007
225	270	145	2162200007
250	300	160	2162500007
300	350	170	2163000007
350	400	180	2163500007
400	450	190	2164000007
450	500	200	2164500007
500	550	210	2165000007

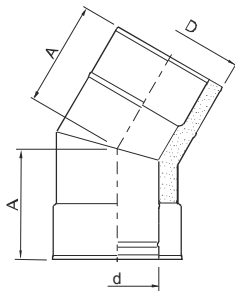

KOLANO 45° invest 217

d	D	A	INDEX
120	180	125	2171200007
130	180	125	2171300007
140	180	125	2171400007
150	200	125	2171500007
160	200	125	2171600007
180	225	130	2171800007
200	250	135	2172000007
225	270	145	2172200007
250	300	160	2172500007
300	350	170	2173000007
350	400	180	2173500007
400	450	190	2174000007
450	500	200	2174500007
500	550	210	2175000007

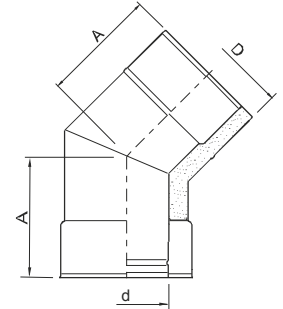

KOLANO 60° invest 250

d	D	A	INDEX
120	180	140	2501200007
130	180	140	2501300007
140	180	140	2501400007
150	200	140	2501500007
160	200	140	2501600007
180	225	160	2501800007
200	250	170	2502000007
225	270	180	2502200007
250	300	195	2502500007
300	350	205	2503000007
350	400	215	2503500007
400	450	240	2504000007
450	500	240	2504500007
500	550	245	2505000007

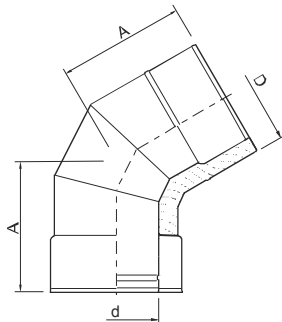

KOLANO 93° invest 218

d	D	A	INDEX
120	180	155	2181200007
130	180	155	2181300007
140	180	155	2181400007
150	200	165	2181500007
160	200	165	2181600007
180	225	180	2181800007
200	250	200	2182000007
225	270	210	2182200007
250	300	215	2182500007
300	350	250	2183000007
350	400	280	2183500007
400	450	305	2184000007
450	500	325	2184500007
500	550	355	2185000007

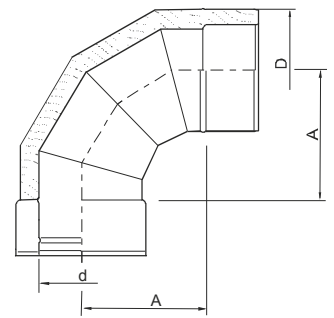

KOLANO Z WYCZYSTKĄ PROSTOKĄTNĄ invest 219

d	D	A	INDEX
120	180	280	2191200007
130	180	280	2191300007
140	180	280	2191400007
150	200	280	2191500007
160	200	280	2191600007
180	225	265	2191800007
200	250	255	2192000007
225	270	265	2192200007
250	300	265	2192500007
300	350	255	2193000007
350	400	285	2193500007
400	450	300	2194000007
450	500	365	2194500007
500	550	380	2195000007

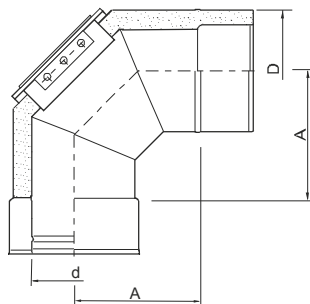

KOLANO Z WYCZYSTKĄ OKRĄGLĄ invest 220

d1	d	D	A	INDEX
120	120	180	200	2201200007
130	180	200	2201300007	
140	180	200	2201400007	
150	200	200	2201500007	
160	200	200	2201600007	
180	225	200	2201800007	
200	250	205	2202000007	
225	270	210	2202200007	
250	300	215	2202500007	
300	350	255	2203000007	
350	400	295	2203500007	
400	450	300	2204000007	
450	500	340	2204500007	
500	550	360	2205000007	

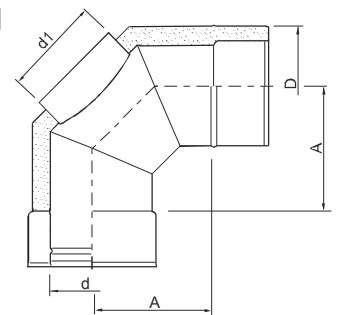

TELESKOP invest 221

d	D	INDEX
120	180	2211200007
130	180	2211300007
140	180	2211400007
150	200	2211500007
160	200	2211600007
180	225	2211800007
200	250	2212000007
225	270	2212200007
250	300	2212500007
300	350	2213000007
350	400	2213500007
400	450	2214000007
450	500	2214500007
500	550	2215000007

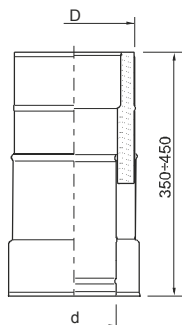

KRÓCIEC POMIAROWY 25 invest 222

d	D	INDEX
120	180	2221200007
130	180	2221300007
140	180	2221400007
150	200	2221500007
160	200	2221600007
180	225	2221800007
200	250	2222000007
225	270	2222200007
250	300	2222500007
300	350	2223000007
350	400	2223500007
400	450	2224000007
450	500	2224500007
500	550	2225000007

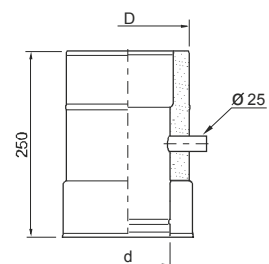

KRÓCIEC POMIAROWY 64 invest 223

d	D	INDEX
120	180	2231200007
130	180	2231300007
140	180	2231400007
150	200	2231500007
160	200	2231600007
180	225	2231800007
200	250	2232000007
225	270	2232200007
250	300	2232500007
300	350	2233000007
350	400	2233500007
400	450	2234000007
450	500	2234500007
500	550	2235000007

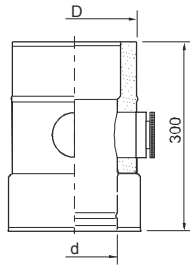

PODPORA PRZEJŚCIOWA invest 224

d	D	A	INDEX
120	180	300	2241200007
130	180	300	2241300007
140	180	300	2241400007
150	200	300	2241500007
160	200	300	2241600007
180	225	D+100	2241800007
200	250	D+100	2242000007
225	270	D+100	2242200007
250	300	D+100	2242500007
300	350	D+100	2243000007
350	400	D+100	2243500007
400	450	D+100	2244000007
450	500	D+100	2244500007
500	550	D+100	2245000007

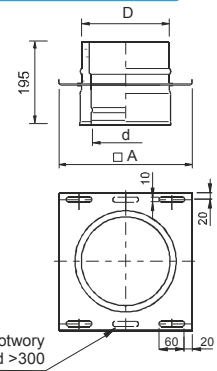

REDUKCJA invest 237

d	D	INDEX
120	180	237120xyz7
130	180	237130xyz7
140	180	237140xyz7
150	200	237150xyz7
160	200	237160xyz7
180	225	237180xyz7
200	250	237200xyz7
225	270	237220xyz7
250	300	237250xyz7
300	350	237300xyz7
350	400	237350xyz7
400	450	237400xyz7
450	500	237450xyz7
500	550	237500xyz7

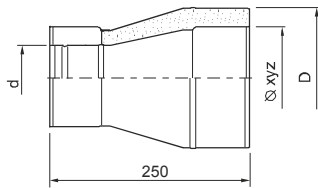

REDUKCJA ODWROTNA invest 238

d	D	INDEX
120	180	238120xyz7
130	180	238130xyz7
140	180	238140xyz7
150	200	238150xyz7
160	200	238160xyz7
180	225	238180xyz7
200	250	238200xyz7
225	270	238220xyz7
250	300	238250xyz7
300	350	238300xyz7
350	400	238350xyz7
400	450	238400xyz7
450	500	238450xyz7
500	550	238500xyz7

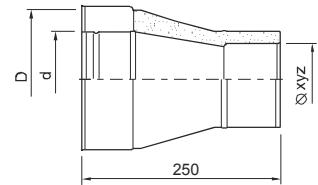

ZŁĄCZKA DWUKIELICHOWA invest 239

d	D	INDEX
120	180	2391200007
130	180	2391300007
140	180	2391400007
150	200	2391500007
160	200	2391600007
180	225	2391800007
200	250	2392000007
225	270	2392200007
250	300	2392500007
300	350	2393000007
350	400	2393500007
400	450	2394000007
450	500	2394500007
500	550	2395000007

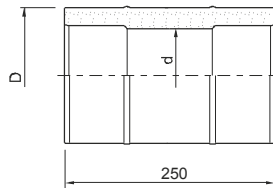

ZŁĄCZKA DWUNYPLOWA invest 240

d	D	INDEX
120	180	2401200007
130	180	2401300007
140	180	2401400007
150	200	2401500007
160	200	2401600007
180	225	2401800007
200	250	2402000007
225	270	2402200007
250	300	2402500007
300	350	2403000007
350	400	2403500007
400	450	2404000007
450	500	2404500007
500	550	2405000007

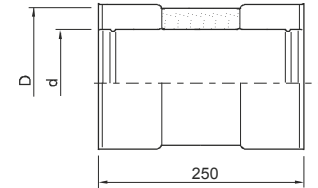

ZAKOŃCZENIE NYPEL-KIELICH invest 241

d	D	INDEX
120	180	2411200007
130	180	2411300007
140	180	2411400007
150	200	2411500007
160	200	2411600007
180	225	2411800007
200	250	2412000007
225	270	2412200007
250	300	2412500007
300	350	2413000007
350	400	2413500007
400	450	2414000007
450	500	2414500007
500	550	2415000007

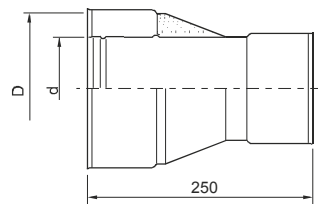

ZAKOŃCZENIE KIELICH-KIELICH invest 242

d	D	INDEX
120	180	2421200007
130	180	2421300007
140	180	2421400007
150	200	2421500007
160	200	2421600007
180	225	2421800007
200	250	2422000007
225	270	2422200007
250	300	2422500007
300	350	2423000007
350	400	2423500007
400	450	2424000007
450	500	2424500007
500	550	2425000007

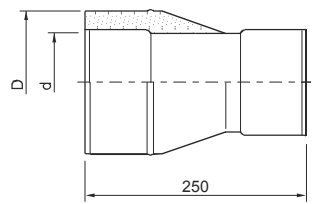

ZAKOŃCZENIE NYPEL-NYPEL invest 262

d	D	INDEX
120	180	2621200007
130	180	2621300007
140	180	2621400007
150	200	2621500007
160	200	2621600007
180	225	2621800007
200	250	2622000007
225	270	2622200007
250	300	2622500007
300	350	2623000007
350	400	2623500007
400	450	2624000007
450	500	2624500007
500	550	2625000007

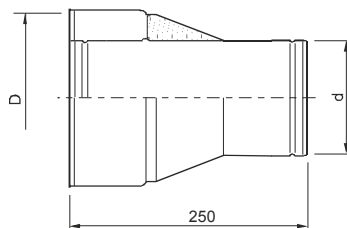

ZAKOŃCZENIE KIELICH-NYPEL invest 263

d	D	INDEX
120	180	2631200007
130	180	2631300007
140	180	2631400007
150	200	2631500007
160	200	2631600007
180	225	2631800007
200	250	2632000007
225	270	2632200007
250	300	2632500007
300	350	2633000007
350	400	2633500007
400	450	2634000007
450	500	2634500007
500	550	2635000007

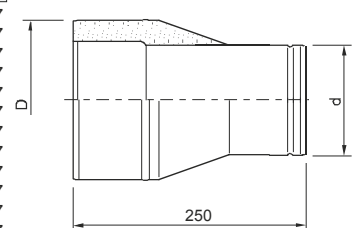

ZAKOŃCZENIE REDUKCYJNE KIELICH-NYPEL invest 291

d	D	INDEX
120	180	291120xyz7
130	180	291130xyz7
140	180	291140xyz7
150	200	291150xyz7
160	200	291160xyz7
180	225	291180xyz7
200	250	291200xyz7
225	270	291220xyz7
250	300	291250xyz7
300	350	291300xyz7
350	400	291350xyz7
400	450	291400xyz7
450	500	291450xyz7
500	550	291500xyz7

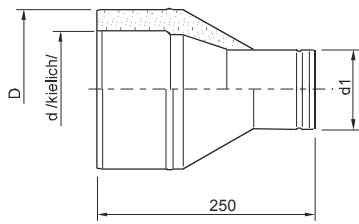

xyz /d1/ - średnica zgodnie z zamówieniem

ZAKOŃCZENIE REDUKCYJNE NYPEL-KIELICH invest 293

d	D	INDEX
120	180	293120xyz7
130	180	293130xyz7
140	180	293140xyz7
150	200	293150xyz7
160	200	293160xyz7
180	225	293180xyz7
200	250	293200xyz7
225	270	293220xyz7
250	300	293250xyz7
300	350	293300xyz7
350	400	293350xyz7
400	450	293400xyz7
450	500	293450xyz7
500	550	293500xyz7

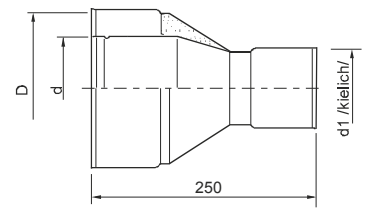

xyz /d1/ - średnica zgodnie z zamówieniem

ZAKOŃCZENIE REDUKCYJNE KIELICH-KIELICH invest 292

d	D	INDEX
120	180	292120xyz7
130	180	292130xyz7
140	180	292140xyz7
150	200	292150xyz7
160	200	292160xyz7
180	225	292180xyz7
200	250	292200xyz7
225	270	292220xyz7
250	300	292250xyz7
300	350	292300xyz7
350	400	292350xyz7
400	450	292400xyz7
450	500	292450xyz7
500	550	292500xyz7

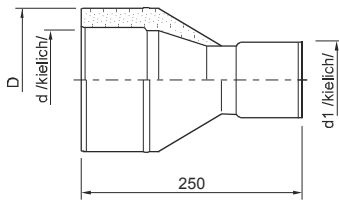

xyz /d1/ - średnica zgodnie z zamówieniem

ZAKOŃCZENIE REDUKCYJNE NYPEL-NYPEL invest 294

d	D	INDEX
120	180	294120xyz7
130	180	294130xyz7
140	180	294140xyz7
150	200	294150xyz7
160	200	294160xyz7
180	225	294180xyz7
200	250	294200xyz7
225	270	294220xyz7
250	300	294250xyz7
300	350	294300xyz7
350	400	294350xyz7
400	450	294400xyz7
450	500	294450xyz7
500	550	294500xyz7

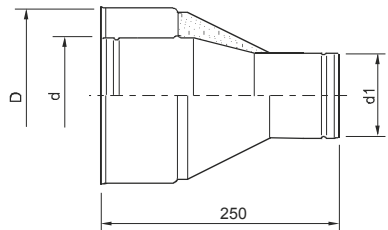

xyz /d1/ - średnica zgodnie z zamówieniem

PRZEDŁUŻKA DO KOMINA invest 236

d	D	A	L	INDEX
120	180	320	1280	2361200007
130	180	320	1280	2361300007
140	180	320	1280	2361400007
150	200	320	1280	2361500007
160	200	320	1280	2361600007
180	225	400	1280	2361800007
200	250	400	1280	2362000007
225	270	400	1280	2362200007
250	300	450	1280	2362500007

Dla L=1280 indeks jest np. 236 120 0007
a dla L=780 indeks jest 236 120 1007

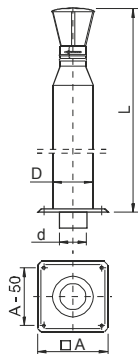

TRÓJNIK REDUKCYJNY 90° invest 256

d	D	INDEX
120	180	256120xyz7
130	180	256130xyz7
140	180	256140xyz7
150	200	256150xyz7
160	200	256160xyz7
180	225	256180xyz7
200	250	256200xyz7
225	270	256220xyz7
250	300	256250xyz7
300	350	256300xyz7
350	400	256350xyz7
400	450	256400xyz7
450	500	256450xyz7
500	550	256500xyz7

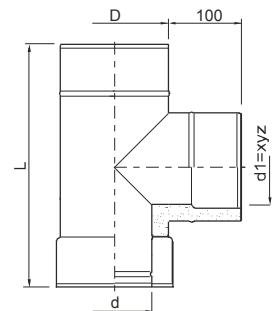

d1	120	130	140	150	160	180	200	225	250	300	350	400	450						
D1	180	180	180	200	200	225	250	270	300	350	400	450	500						
L	400						450			500		550		600		650		700	

TRÓJNIK REDUKCYJNY 45° invest 259

d	D	INDEX
120	180	259120xyz7
130	180	259130xyz7
140	180	259140xyz7
150	200	259150xyz7
160	200	259160xyz7
180	225	259180xyz7
200	250	259200xyz7
225	270	259220xyz7
250	300	259250xyz7
300	350	259300xyz7
350	400	259350xyz7
400	450	259400xyz7
450	500	259450xyz7
500	550	259500xyz7

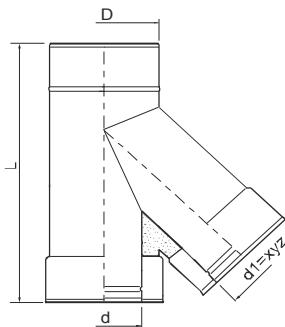

d1	120	130	140	150	160	180	200	225	250	300	350	400	450							
D1	180	180	180	200	200	225	250	270	300	350	400	450	500							
L	450					500			570		700		800		800		900		1000	

ODSKRAPLACZ Z PODSTAWKĄ invest 248

d	D	A	INDEX
120	180	300	2481201007
130	180	300	2481301007
140	180	300	2481401007
150	200	300	2481501007
160	200	300	2481601007
180	225	330	2481801007
200	250	380	2482001007
225	270	380	2482201007
250	300	430	2482501007

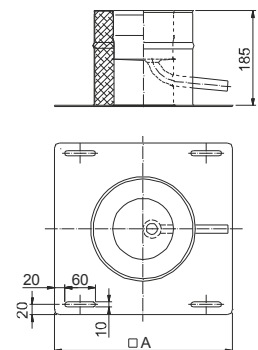

TRÓJNIK 90° Z WYCZYSTKĄ invest 208

d	D	L	INDEX
120	180	500	2081200007
130	180	500	2081300007
140	180	500	2081400007
150	200	500	2081500007
160	200	500	2081600007
180	225	500	2081800007
200	250	500	2082000007
225	270	500	2082200007
250	300	500	2082500007
300	350	550	2083000007
350	400	600	2083500007
400	450	650	2084000007
450	500	700	2084500007
500	550	750	2085000007

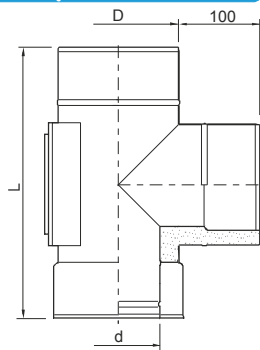

RURA DYSTANSOWA invest 256

INDEX			
d	D	L=500	L=1000
120	180	2561200007	2561201007
130	180	2561300007	2561301007
140	180	2561400007	2561401007
150	200	2561500007	2561501007
160	200	2561600007	2561601007
180	225	2561800007	2561801007
200	250	2562000007	2562001007
225	270	2562200007	2562201007
250	300	2562500007	2562501007
300	350	2563000007	2563001007
350	400	2563500007	2563501007
400	450	2564000007	2564001007
450	500	2564500007	2564501007
500	550	2565000007	2565001007

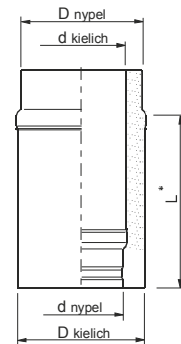

* - długość dopasować przycinając odpowiednio rurę wew. i zew.

TRÓJNIK 45° Z WYCZYSTKĄ invest 266

d	D	A	L	INDEX
120	180	350	500	2661200007
130	180	350	500	2661300007
140	180	350	500	2661400007
150	200	350	500	2661500007
160	200	350	500	2661600007
180	225	400	570	2661800007
200	250	400	570	2662000007
225	270	420	570	2662200007
250	300	500	700	2662500007
300	350	550	800	2663000007
350	400	600	800	2663500007
400	450	680	900	2664000007
450	500	780	1000	2664500007
500	550	760	1000	2665000007

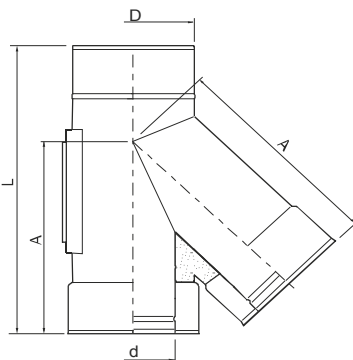

ZATYCZKA PERFOROWANA invest 298

d	D	INDEX
120	180	2981201007 2981200007
130	180	2981301007 2981300007
140	180	2981401007 2981400007
150	200	2981501007 2981500007
160	200	2981601007 2981600007
180	225	2981801007 2981800007
200	250	2982001007 2982000007
225	270	2982201007 2982200007
250	300	2982501007 2982500007
300	350	2983001007 2983000007
350	400	2983501007 2983500007
400	450	2984001007 2984000007
450	500	2984501007 2984500007
500	550	2985001007 2985000007

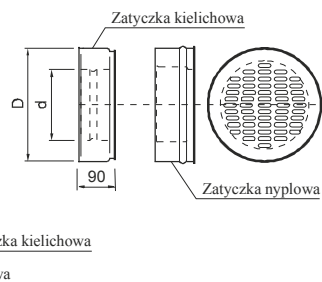

ELEMENT NIETYPOWY

999

Elementy niekatalogowe wykonywane są na podstawie rysunków dostarczonych przez klienta. Wycena takich elementów jest oparta na indywidualnej kalkulacji.